

# MCDA 外觀尺寸 $\phi 6 \sim \phi 32$

## 雙軸倍力缸

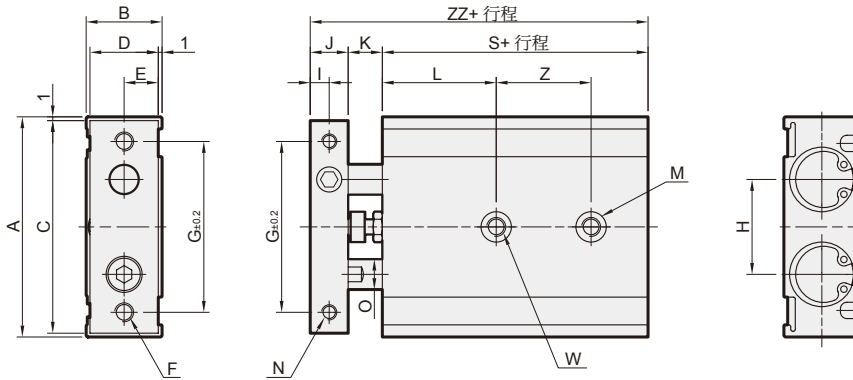

$\phi 12, \phi 16$

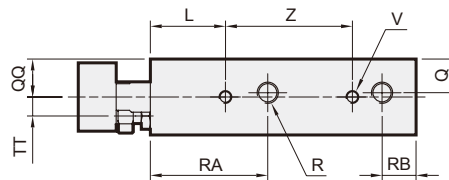

$\phi 20 \sim \phi 32$

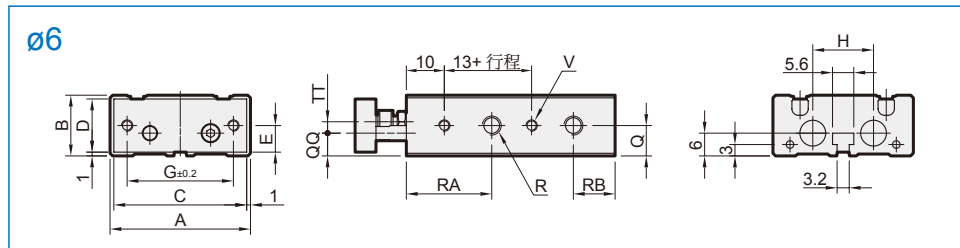
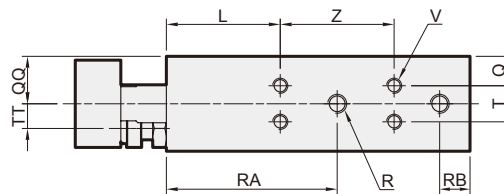

### MCDA-03 / 23

代號 內徑	A	B	C	D	E	F (貫通)	G	H	I	J	K	L	M (兩側)	N (兩側)	O	Q	QQ	R (兩側)	RA	RB	S	T
6	37	16	35	14	7	2-M3×0.5	28	16	2.75	5.5	8	13	2- $\phi 6.5 \times 3.3$ 深 *1	2-M3×0.5 貫通	4	8	6	4-M5×0.8	22.5	11	45	-
12	46	18	44	16	8	2-M4×0.7	35	19	4	8	9	20	4- $\phi 6.5 \times 3.3$ 深	4-M3×0.5×5 深	6	9	10	4-M5×0.8	30	8	55	-
16	58	20	56	18	9	2-M5×0.8	45	25	5	10	9	30	4- $\phi 8 \times 4.4$ 深	4-M4×0.7×6 深	8	10	10	4-M5×0.8	38.5	8	60	-
20	64	25	62	23	11.5	2-M5×0.8	50	28	6	12	12	30	4- $\phi 9.5 \times 5.3$ 深	4-M4×0.7×6 深	10	7.75	12.5	4-M5×0.8	45	8	70	9.5
25	80	30	78	28	14	2-M6×1.0	60	35	6	12	12	30	4- $\phi 11 \times 6.3$ 深	4-M5×0.8×8 深	12	8.5	15	4-Rc1/8	46	9	72	13
32	98	38	96	36	18	2-M6×1.0	75	44	8	16	14	30	4- $\phi 11 \times 6.3$ 深	4-M5×0.8×8 深	16	9	19	4-Rc1/8	56	10	82	20

代號 內徑	TT	V (兩側)	W (貫通)	Z (行程)							ZZ
				10,15,20,25	30,35,40,45,50	60,70,75,80	90,100	110,120,125	150	175,200	
6	3	4-M3×0.5×4.5 深	2- $\phi 3.4$	10+1/2 行程 *2							58.5
12	3.5	4-M3×0.5×4.5 深	2-M4×0.7	30	40	50	60	70	80	-	72
16	5	4-M4×0.7×5 深	2-M5×0.8	25	35	45	55	65	75	-	79
20	6.5	8-M4×0.7×5.5 深	2-M6×1.0	30	40	60		80	100		94
25	9	8-M5×0.8×7.5 深	2-M8×1.25	30	40	60		80	100		96
32	11.5	8-M5×0.8×7.5 深	2-M8×1.25	40	50	70		90	110		112

\*1.  $\phi 6$  - 單側  
\*2.  $\phi 6$  - 行程 (10, 20, 30, 40, 50)