



Features

■ Non lubrication

- Special housing and bushing enables self lubrication of piston rod.

■ High quality long service life

- Hard anodised stainless steel cylinder tubes offer a high resistance to corrosion and low internal friction.
- Cylinder mountings, available with a comprehensive range of accessories for rigid or flexible mounting.

■ Magnetic as standard

Specification

Model		MCMB			
Tube I.D.		20	25	32	40
Port size		Rc1/8			Rc1/4
Medium		Air			
Max. operating pressure		1 MPa			
Min. operating pressure	Double acting	0.05 MPa			
	Single acting	Extended: 0.23, Returned: 0.18 MPa			
Proof pressure		1.5 MPa			
Lubricator		Not required			
Ambient temperature		-5~+60°C (No freezing)			
Available speed range		50~750 mm/sec			
Max. allowable kinetic energy (J)	Cushion pad	0.27	0.4	0.65	1.2
	Cushion air	0.54	0.78	1.27	2.35
Sensor switch		RCM (Please refer to page 8-16)			
Sensor switch (band)		BM20	BM25	BM32	BM40

Table for standard stroke

Tube I.D.	Stroke (mm)
ø20,25,32,40	25,50,75,100,125,150,200,250,300

Order example

MCMB - 11 - 20 - 50 - A - N - G

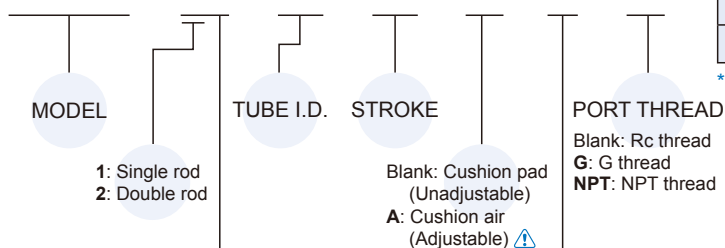

Code	Symbol	Description
1 1		Double acting / Male thread
1 3		Single acting / Normally extended male thread
1 5		Single acting / Normally returned male thread
2 1		Double rod / Male thread
2 7		Double rod / Adjustable male thread Please mark "adjustable distance(mm)" at order list

Code	Symbol	Description
Blank		Standard type
N		End-plain
E		With pivot type

* Single acting type, please contact us.

* Order example for special specification, refer to page 0-7.

⚠ Caution

For (A) Cushion air (Adjustable)

1. To adjust a cushion needle, please slowly turn the needle valve from the fully closed status to the required status which needs to be within 2.5 turns.
2. If the needle valve loosen excessively, the buffer doesn't take effect and the lifetime of cylinder would be shortened.

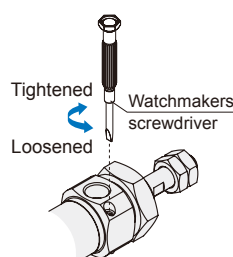

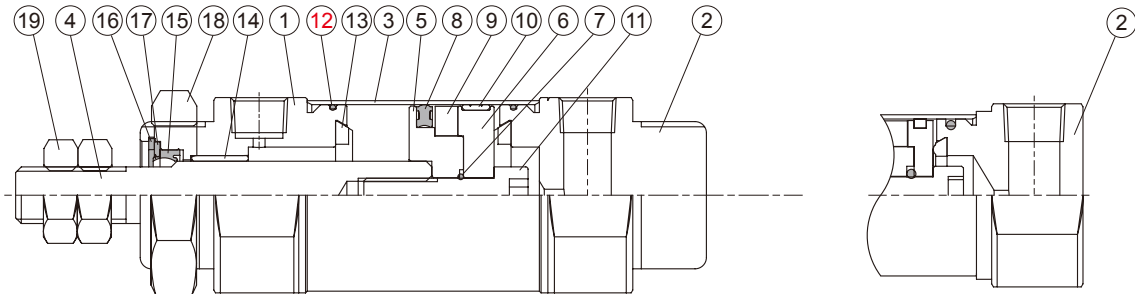

N type

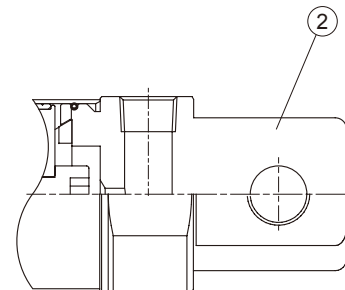

E type

Material

No.	Tube I.D. Part name	20	25	32	40	Q'y		Component parts (inclusion)	
						11 type	21 type	11 type	21 type
1	Rod cover	Aluminum alloy				1	2	●	●
2	Head cover	Aluminum alloy				1	–	●	
3	Tube	Stainless steel				1	1		
4	Piston rod	Carbon steel				1	1		
5	Piston-R	Aluminum alloy				1	1	●	●
6	Piston-H	Aluminum alloy				1	1	●	●
7	Piston gasket	NBR				1	1	●	●
8	Piston packing	NBR				1	1	●	●
9	Magnet ring	Magnet material				1	1	●	●
10	Wear ring	Resin				1	1	●	●
11	Piston bolt	SCM				1	–	●	
12	Cover ring	–		NBR		2	2	●	●
13	Cushion gasket	NBR				2	2	●	●
14	Rod bush	Bearing alloy				1	2	●	●
15	Rod packing *1	NBR				1	2	●	●
16	Snap ring	Spring steel				1	2	●	●
17	Washer	Carbon steel				1	2	●	●
18	Tie nut	Carbon steel				1	2	●	●
19	Rod front nut	Carbon steel				2	2	●	●

*1. Only the rod packing is repairable, please contact our sales if needed.

Order example of Component parts

Tube I.D.	Component parts
ø20	CP-MCMB-20
ø25	CP-MCMB-25
ø32	CP-MCMB-32
ø40	CP-MCMB-40

Non-pivot type (End-plain)

Tube I.D.	Component parts
ø20	CP-MCMB-20-N
ø25	CP-MCMB-25-N
ø32	CP-MCMB-32-N
ø40	CP-MCMB-40-N

Pivot type

Tube I.D.	Component parts
ø20	CP-MCMB-20-E
ø25	CP-MCMB-25-E
ø32	CP-MCMB-32-E
ø40	CP-MCMB-40-E

MINIATURE CYLINDER

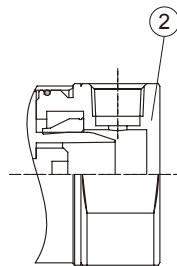
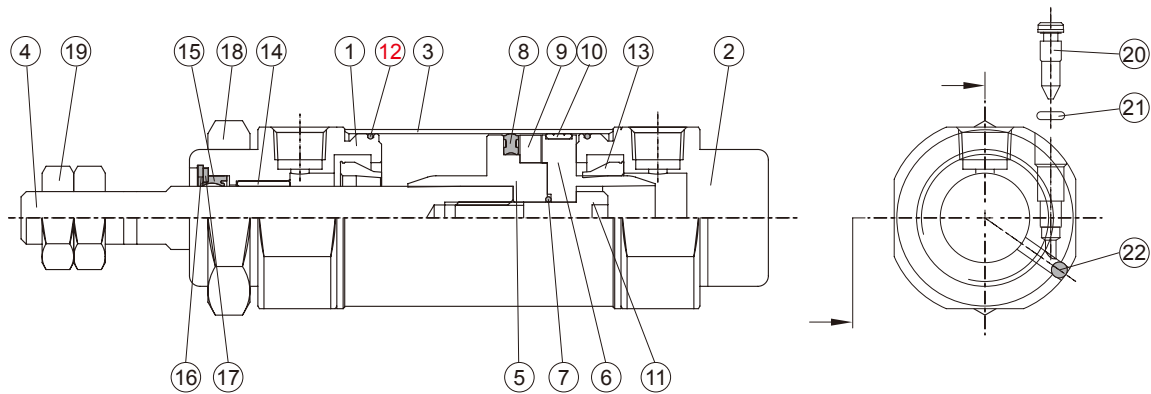

N type

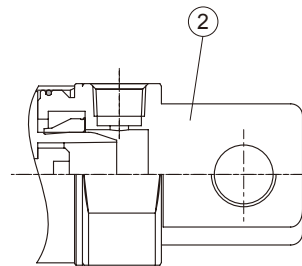

E type

Material

No.	Tube I.D. Part name	20	25	32	40	Q'y		Component parts (inclusion)	
						11 type	21 type	11 type	21 type
1	Rod cover	Aluminum alloy				1	2	●	●
2	Head cover	Aluminum alloy				1	—	●	
3	Tube	Stainless steel				1	1		
4	Piston rod	Carbon steel				1	1		
5	Piston-R	Aluminum alloy				1	1	●	●
6	Piston-H	Aluminum alloy				1	1	●	●
7	Piston gasket	NBR				1	1	●	●
8	Piston packing	NBR				1	1	●	●
9	Magnet ring	Magnet material				1	1	●	●
10	Wear ring	Resin				1	1	●	●
11	Piston bolt	SCM				1	—	●	
12	Cover ring	—	NBR			2	2	●	●
13	Cushion packing	NBR				2	2	●	●
14	Rod bush	Bearing alloy				1	2	●	●
15	Rod packing *1	NBR				1	2	●	●
16	Snap ring	Spring steel				1	2	●	●
17	Washer	Carbon steel				1	2	●	●
18	Tie nut	Carbon steel				1	2	●	●
19	Rod front nut	Carbon steel				2	2	●	●
20	Needle valve	Stainless steel	Carbon steel			2	2	●	●
21	Needle valve packing	NBR				2	2	●	●
22	Steel ball	Stainless steel				2	2	●	●

*1. Only the rod packing is repairable, please contact our sales if needed.

Order example of Component parts

Tube I.D.	Component parts
ø20	CP-MCMB-20A
ø25	CP-MCMB-25A
ø32	CP-MCMB-32A
ø40	CP-MCMB-40A

Non-pivot type (End-plain)

Tube I.D.	Component parts
ø20	CP-MCMB-20A-N
ø25	CP-MCMB-25A-N
ø32	CP-MCMB-32A-N
ø40	CP-MCMB-40A-N

Pivot type

Tube I.D.	Component parts
ø20	CP-MCMB-20A-E
ø25	CP-MCMB-25A-E
ø32	CP-MCMB-32A-E
ø40	CP-MCMB-40A-E