

SLIDE CYLINDER

Order example of stroke adjuster

MCSS – 20 L – AS – X12

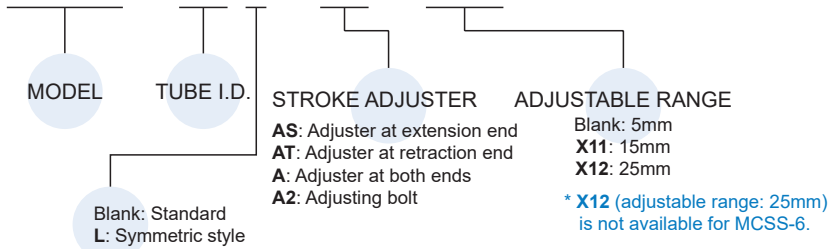

AS Stroke adjuster at extension end (Standard and symmetric style share the same order code)

Mounted to body

Material: Aluminum alloy

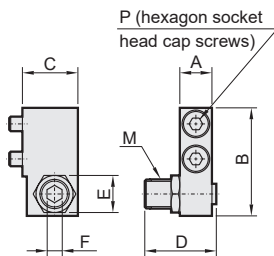

Tube I.D.	Order code	Adjustable stroke range (mm)	Mounted to body								Mounted to table			
			A	B	C	D	E	F	M	P	H	I	J	Q
6	MCSS-6-AS	5	6	17.8	10.5	16.5	7	2.5	M5×0.8	M2.5×10	12.5	6	8.5	M2.5×8
	MCSS-6-AS-X11	15				26.5								
8	MCSS-8-AS	5	7	21.5	11	16.5	8	3	M6×1	M3×10	14.6	7	10	M3×10
	MCSS-8-AS-X11	15				26.5								
	MCSS-8-AS-X12	25				36.5								
12	MCSS-12-AS	5	9.5	31	16	20	11	4	M8×1	M4×16	18.5	10	13	M4×12
	MCSS-12-AS-X11	15				30								
	MCSS-12-AS-X12	25				40								
16	MCSS-16-AS	5	11	37	19	24.5	14	5	M10×1	M5×16	21	12	16.5	M5×16
	MCSS-16-AS-X11	15				34.5								
	MCSS-16-AS-X12	25				44.5								
20	MCSS-20-AS	5	13	45.5	24	27.5	17	6	M12×1.25	M6×20	25	13	21	M6×20
	MCSS-20-AS-X11	15				37.5								
	MCSS-20-AS-X12	25				47.5								
25	MCSS-25-AS	5	16	53.5	26.5	32.5	19	6	M14×1.5	M8×25	31	17	25.5	M8×25
	MCSS-25-AS-X11	15				42.5								
	MCSS-25-AS-X12	25				52.5								

Mounted to table

Material: Aluminum alloy

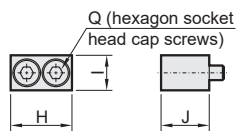

AT Stroke adjuster at retraction end ($\varnothing 6, \varnothing 8$: Standard and symmetric style share the same order code)

Mounted to body

Material: Aluminum alloy

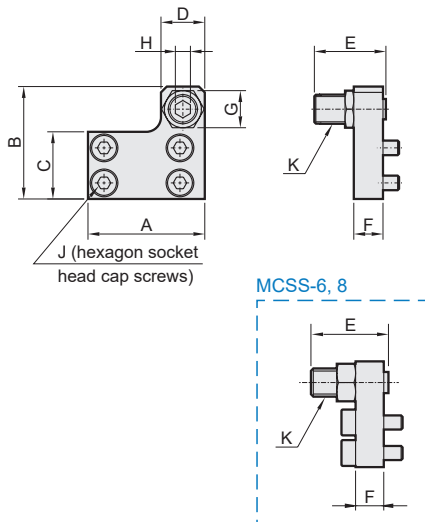

Tube I.D.	Order code	Adjustable stroke range (mm)	A	B	C	D	E	F	G	H	J	K
6	MCSS-6-AT	5	21	19	10.5	8	16.5	5	7	2.5	M2.5×8	M5×0.8
	MCSS-6-AT-X11	15					26.5					
8	MCSS-8-AT	5	25	22.5	12.5	9	16.5	6	8	3	M3×10	M6×1
	MCSS-8-AT-X11	15					26.5					
	MCSS-8-AT-X12	25					36.5					
12	MCSS-12□-AT	5	32	31	18.5	13	20	8	12	4	M4×8	M8×1
	MCSS-12□-AT-X11	15					30					
	MCSS-12□-AT-X12	25					40					
16	MCSS-16□-AT	5	40	38.5	23	15	24.5	10	14	5	M5×10	M10×1
	MCSS-16□-AT-X11	15					34.5					
	MCSS-16□-AT-X12	25					44.5					
20	MCSS-20□-AT	5	50	48	29	21	27.5	12	17	6	M5×12	M12×1.25
	MCSS-20□-AT-X11	15					37.5					
	MCSS-20□-AT-X12	25					47.5					
25	MCSS-25□-AT	5	60	58	35	23	32.5	15	19	6	M6×16	M14×1.5
	MCSS-25□-AT-X11	15					42.5					
	MCSS-25□-AT-X12	25					52.5					

* □ For standard and symmetric style options.

SLIDE CYLINDER

A2 Adjusting bolt (Standard and symmetric style share the same order code)

Material: Stainless steel

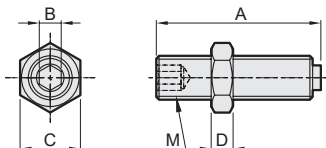

Tube I.D.	Order code	Adjustable stroke range (mm)	A	B	C	D	M
6	MCSS-6-A2	5	16.5	2.5	7	4	M5×0.8
	MCSS-6-A2-X11	15	26.5				
8	MCSS-8-A2	5	16.5	3	8	4	M6×1
	MCSS-8-A2-X11	15	26.5				
	MCSS-8-A2-X12	25	36.5				
12	MCSS-12-A2	5	20	4	11	4	M8×1
	MCSS-12-A2-X11	15	30				
	MCSS-12-A2-X12	25	40				
16	MCSS-16-A2	5	24.5	5	14	4	M10×1
	MCSS-16-A2-X11	15	34.5				
	MCSS-16-A2-X12	25	44.5				
20	MCSS-20-A2	5	27.5	6	17	5	M12×1.25
	MCSS-20-A2-X11	15	37.5				
	MCSS-20-A2-X12	25	47.5				
25	MCSS-25-A2	5	32.5	6	19	6	M14×1.5
	MCSS-25-A2-X11	15	42.5				
	MCSS-25-A2-X12	25	52.5				

Cylinder weight

Unit: g

Model	Stroke (mm)									Adjuster		Absorber		End lock
	10	20	30	40	50	75	100	125	150	AS	AT	BS	BT	
MCSS-6(L)	89	110	122	161	199	-	-	-	-	10	10	-	-	-
MCSS-8(L)	155	166	201	246	281	394	-	-	-	18	18	31	41	40
MCSS-12(L)	360	362	369	425	529	722	960	-	-	40	36	46	57	92
MCSS-16(L)	576	600	602	674	762	1095	1410	1702	-	67	66	76	101	168
MCSS-20(L)	1050	1060	1092	1145	1320	1815	2365	2880	3368	113	111	173	211	316
MCSS-25(L)	1636	1650	1673	1797	1989	2713	3260	4260	4530	198	185	239	309	562

AS/ BS: Extension end
AT/ BT: Retraction end

SLIDE CYLINDER

Order example of absorber

MCSS – 20 L – B – P

MODEL

TUBE I.D.
8~25

ABSORBER

BS: Absorber at extension end
BT: Absorber at retraction end
B: Absorber at both ends

Blank: Standard
L: Symmetric style

APPLICABLE RANGE
(Only for absorber code B)

Tube I.D.	Stroke	
	Blank: Mounted to table $\times 1$	P: Mounted to table $\times 2$
8	10~40	50,75
12	10~50	75,100
16	10~50	75~125
20	10~75	100~150
25	10~75	100~150

BS Stroke adjuster at extension end (Standard and symmetric style share the same order code)

Mounted to body

Material: Aluminum alloy

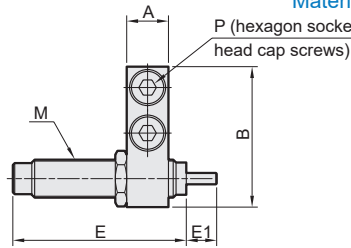
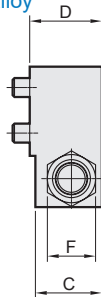

Mounted to table

Material: Carbon steel

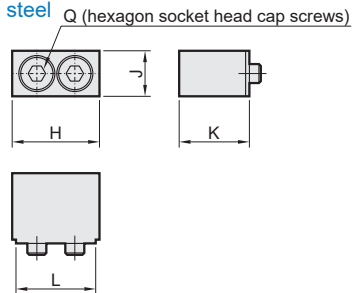

Tube I.D.	Order code	Mounted to body										Mounted to table				
		A	B	C	D	E	E1	F	M	P	H	J	K	L	Q	
8	MCSS-8-BS	7	23	14	15.5	38.5	6	11	M8 \times 1	MDSC-0806-3-N	M3 \times 16	16.6	7	15.5	14.6	M3 \times 16
12	MCSS-12-BS	9.5	31	14.5	16	38.5	6	11	M8 \times 1	MDSC-0806-3-N	M4 \times 16	20.5	10	15	18.5	M4 \times 12
16	MCSS-16-BS	11	37	17.5	19	45.5	8	12.7	M10 \times 1	MDSC-1008-3-N	M5 \times 16	23	12	18.5	21	M5 \times 16
20	MCSS-20-BS	13	47	23.5	26	67.5	12	19	M14 \times 1.5	MDSC-1412-3-N	M6 \times 25	27	13	25.5	25	M6 \times 25
25	MCSS-25-BS	16	53.5	23.5	26.5	67.5	12	19	M14 \times 1.5	MDSC-1412-3-N	M8 \times 25	33	17	25.5	31	M8 \times 25

BT Stroke adjuster at retraction end ($\varnothing 8$: Standard and symmetric style share the same order code)

Mounted to body

Material: Aluminum alloy

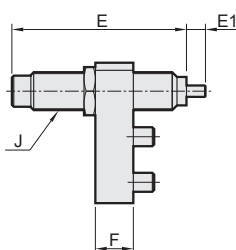
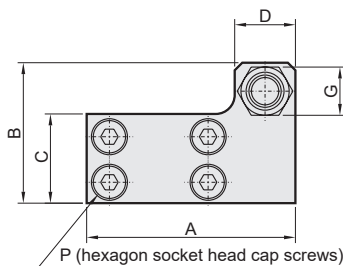

MCSS-8

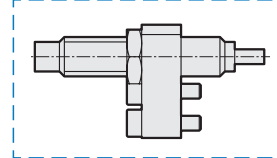

Mounted to table

Material: Carbon steel

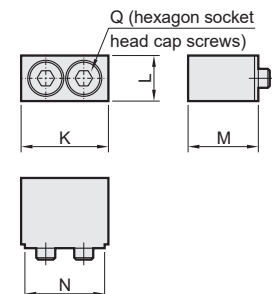

Tube I.D.	Order code	Mounted to body										Mounted to table					
		A	B	C	D	E	E1	F	G	J	P	K	L	M	N	Q	
8	MCSS-8-BT	38	23	12.5	14	38.5	6	8	12	M8 \times 1	MDSC-0806-3-N	M3 \times 12	16.6	7	15.5	14.6	M3 \times 16
12	MCSS-12□-BT	45	31	18	14	38.5	6	8	11	M8 \times 1	MDSC-0806-3-N	M4 \times 8	20.5	10	15	18.5	M4 \times 12
16	MCSS-16□-BT	55	37	23.5	16	45.5	8	10	12.7	M10 \times 1	MDSC-1008-3-N	M5 \times 10	23	12	18.5	21	M5 \times 16
20	MCSS-20□-BT	70	47	29	23	67.5	12	12	19	M14 \times 1.5	MDSC-1412-3-N	M5 \times 12	27	13	25.5	25	M6 \times 25
25	MCSS-25□-BT	80	54	35	23	67.5	12	15	19	M14 \times 1.5	MDSC-1412-3-N	M6 \times 16	33	17	25.5	31	M8 \times 25

* □ For standard and symmetric style options.