

LB End cover bracket (foot)

$\varnothing 16, \varnothing 25$

Material: Carbon steel

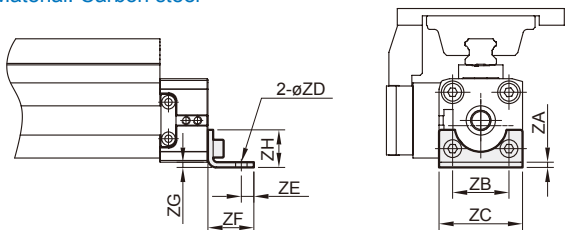

LB1 End cover bracket (foot)

$\varnothing 32^*$

Material: Aluminum alloy

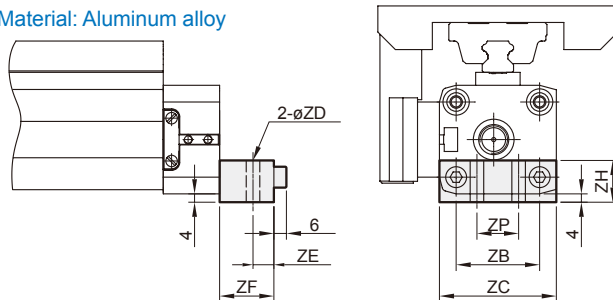

$\varnothing 32, \varnothing 40$

Material: Aluminum alloy

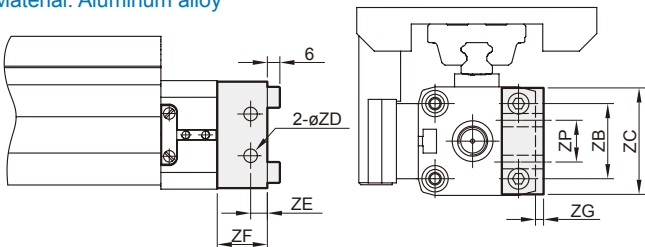

Code Tube I.D.	ZA	ZB	ZC	ZD	ZE	ZF	ZG	ZH	ZP
16	1.6	18	26	3.6	4	14	1.5	12.5	--
25	2.5	27	40	5.5	6	22	2.5	18	--
32	--	36	51	6.5	8	24	4	20	20
32*	--	40	56	6.5	8	26	4	20	20
40	--	54	71	9	11.5	24	2	20	30

Absorber group

Body fixed group

Material: Aluminum alloy (body fixed block)

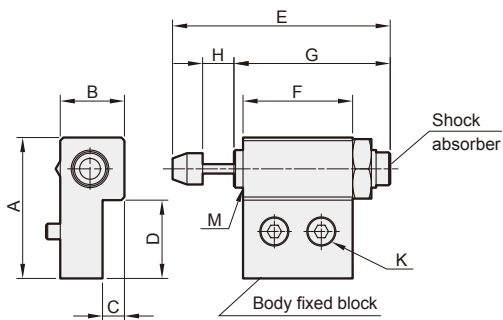

Stop block

Material: Aluminum alloy

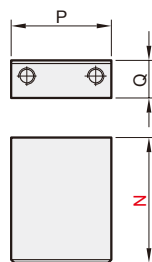

With shock absorber

- Do not rotate the screw set on bottom of shock absorber.**
This is not the screw for adjusting. If this screw is rotated, it may cause oil leakage.
- Do not scratch the exposed portion of the piston rod.**
Decrease in life or malfunction may result.
- Shock absorber is considered a consumable component. When energy absorption is decreased, replace it.**

Code Tube I.D.	Body fixed group									Stop block			
	A	B	C	D	E	F	G	H	K	M	N	P	Q
16	45	23.5	10	25	41.2	20	31.7	5	M5×12L	M10×1.0	25	22	10
25	45	20.5	7	25	69.5	35	49.9	10	M5×12L	M12×1.0	32	32	12
32, 40	45	20.5	7	25	98.7	40	76	12	M5×12L	M14×1.5	40	60	20

Model	Shock absorber			
	Model	L	M	H
MCRPLK-16	MAC1005-	1	2	3
MCRPLK-25	MAC1210-	1	2	3
MCRPLK-32	MAC1412-	1	2	3
MCRPLK-40	MAC1412-	1	2	3