



Selector table



Applications



Motor selection



Controller



Feature

- Excellent resistance to torque and radial loads.
- Four self-lubricating bushes or linear bearings enable high loading and precise movement.
- Simple structure.

Motor type	Servo / Step	Transmission	Ball screw
Environment	Standard	Guide type	Slide guide
MEGTX	Light duty flange type		
MEGTB	Heavy duty (bush) type		
MEGTU	Heavy duty (linear bearing) type		

Model	MEGTX / MEGTB / MEGTU											
Size	32			40			50			63		
Positioning repeatability (mm)	±0.02											
Lead *1 (mm)	1	2	5	10	20	5	10	20	5	10	20	
Ball screw (ø)	C7ø8			C7ø12			C7ø16			C7ø20		
Stroke (mm)	100~400			100~600			100~800			100~1000		
Anti-rotation tolerance (°)	±0.4											
Start torque (N.m)	<0.05	<0.1	<0.05	<0.1	<0.2	<0.2	<0.25	<0.3	<0.3	<0.35	<0.4	
Sensor switch	RDC(V), RQC(V)											

With AC servo motor (W)	50 (100)						200 (400)					
Max. speed (mm/s)	50	100	250	500	1000	250	500	1000	250	500	1000	
Max. axial force (N)	720 (1600)	360 (800)	140 (320)	70 (160)	35 (80)	680 (1400)	340 (700)	170 (350)	680 (1400)	340 (700)	170 (350)	
Rated axial load *2 (kg)	3.3	5.5	23	27	37	38.5	35.5	27	50.5	64	37	

With step motor	□42						□56					
Max. speed (mm/s)	50	100	250	500	1000	250	500	1000	250	500	1000	
Max. thrust force at top speed *3 (N)	325	162	65	32	16	110	55	27	110	55	27	

*1. Special accuracy and lead are available.

*2. The rated load refers to a 10,000 km estimated service life. Please refer to the "Capacity" page in the MEQI series for information on other load conditions.

*3. Due to the characteristics of a step motor, thrust force is low at high speed. Lowering the operating speed can further increase the thrust force.

Order example

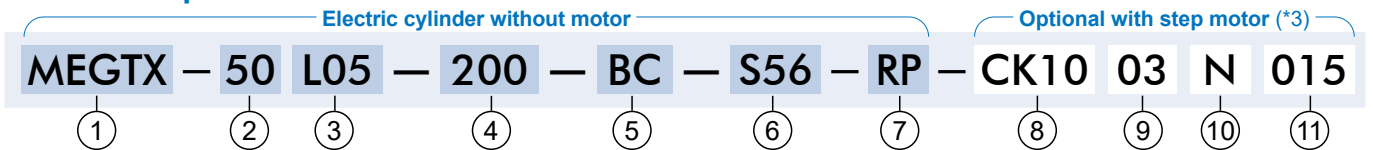

Model	Size	Ball screw lead	Stroke	Size	Flange (For motor installation)			Controller	Motor	Motor + Encoder cable					
 MEGTX	32	L01	1 mm	100~400	M	Mitsubishi Yaskawa Delta	10	50/100W servo	32, 40	CK10	SM (for S42, S56)	01	1 m (CM20 only)		
		L02	2 mm	100~600			40	200/400W servo	50, 63			CM20 *	BM (for B42, B56)	015	1.5 m (CK10 only)
	50 63	L05	5 mm	100~800	P	Panasonic	10	50/100W servo	32, 40	10	I/O type			N	NPN
		L10	10 mm	100~1000			40	400W servo	50, 63			05	5 m		
 MEGTB	40	L20	20 mm	63	S	Mindman	42	□42 Step NEMA 17	32, 40	11	I/O cable length	015	1.5 m (standard)		
		L20	20 mm				56	□56 Step NEMA 23	50, 63			03	3 m		
 MEGTU	Motor position BC Direct connection BA Turned		Rear flange coupling (*2) RP												

*1. Motor not included. Please refer to the "Motor selection table".

*2. Not suitable for motor turned type (BA).

*3. For the optional transmission cable (CK10-C035) for controller management.

Maximum allowable torque moment

Max. allowable load

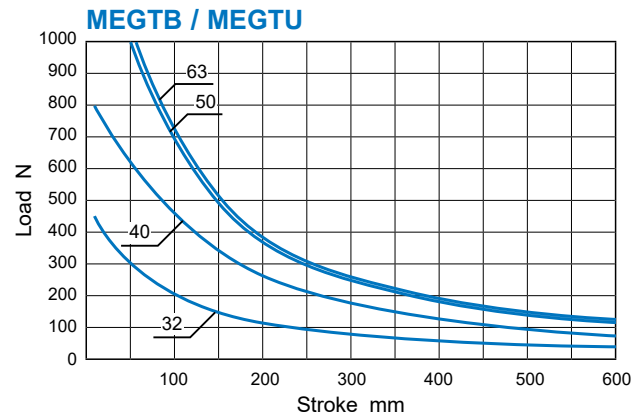
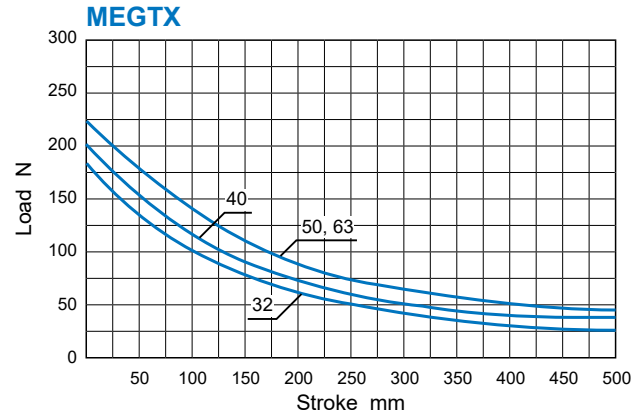
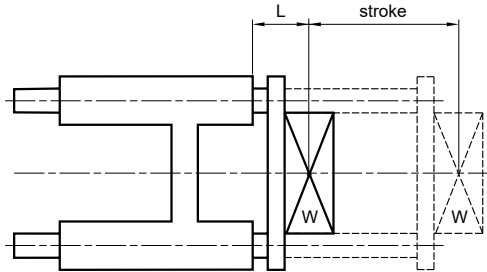

Maximum allowable torque moment

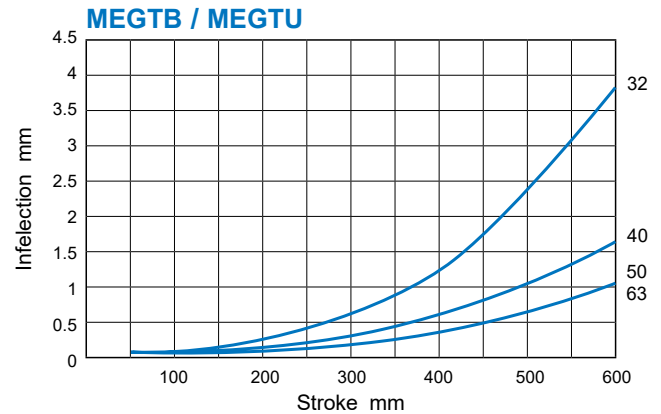
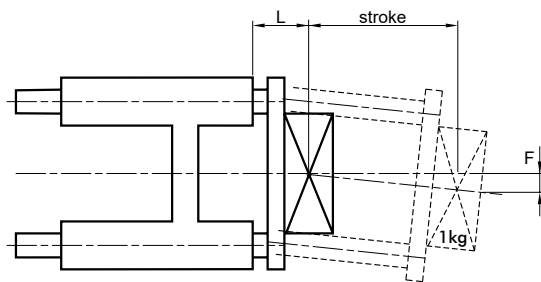

Max. allowable bending offset

Inflection of guide stems is due to their weight summed to the load of 1Kg related to the stroke.

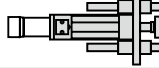
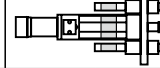
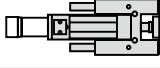

Weight

Unit: kg

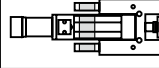
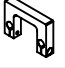
Model	MEGTX (Flange type)				MEGTB (Brass bush guide)				MEGTU (Linear bearing guide)				RP
	Basic weight		Stroke 100 mm		Basic weight		Stroke 100 mm		Basic weight		Stroke 100 mm		
Fig													
Motor	BC	BA	BC	BA	BC	BA	BC	BA	BC	BA	BC	BA	-
32	1.83	1.98	0.574		2.62	2.77	0.574		2.47	2.62	0.574		0.132
40	3.26	3.26	0.802		4.60	4.60	0.802		4.29	4.29	0.802		0.241
50	4.76	5.17	1.178		6.90	7.31	1.178		6.48	6.89	1.178		0.383
63	6.53	6.77	1.526		9.13	9.37	1.526		8.70	8.94	1.526		0.499

MEGTX (Flange type)

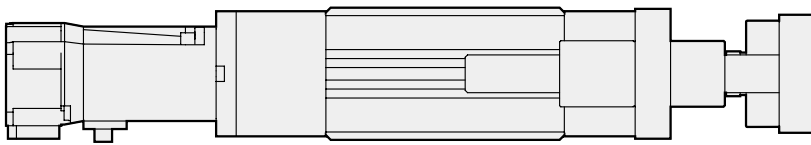

BC

Motor direct connection

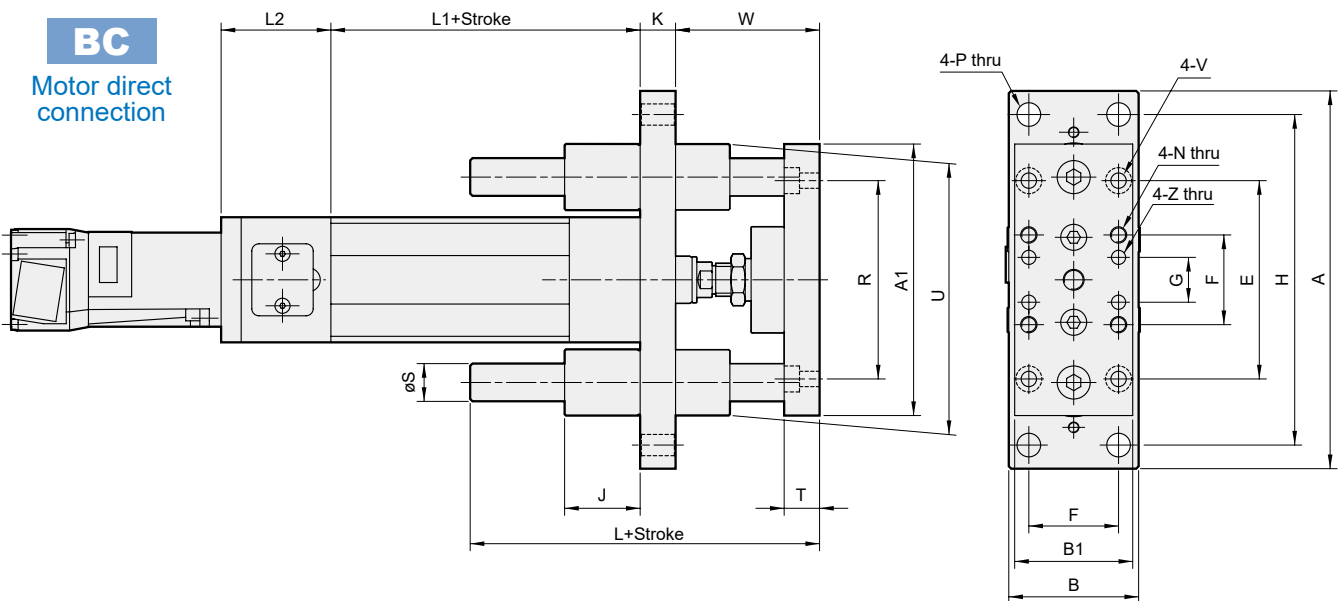

BA

Motor Turned

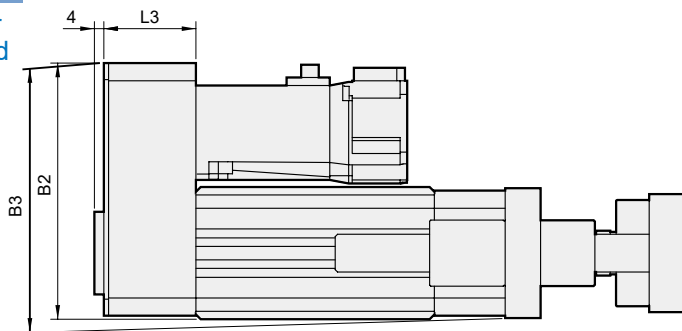

Size 32

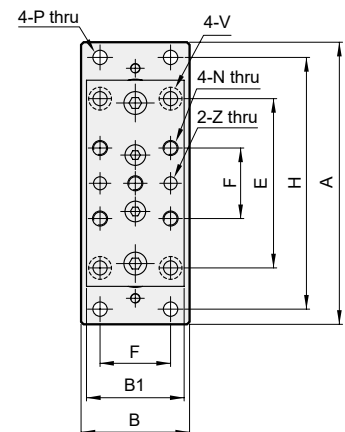

Code Size	A	A1	B	B1	B2	B3	E	F	G	H	J	K	L	L1	L2	L3	N	P	R	S	T	U	V	W	Z
32	130	95	50	45	100	100.5	78	32.5	-	116	25.5	15	135.5	87	51	42	M6×1.0	ø6.6	74	12	15	95	ø6.5, ø10.5×6.5 dp	55	ø6H7×15 dp
40	160	115	55	50	108.5	108	84	38	19	140	32	15	148	131	46.5	39	M6×1.0	ø9	87	16	15	115	ø6.5, ø11×6.5 dp	61	ø6H7×15 dp
50	180	135	70	65	142.5	142.5	100	46.5	23	160	36	20	170	152	59.5	50	M8×1.25	ø9	104	20	20	136	ø9, ø14×8.5 dp	74	ø6H7×20 dp
63	195	150	80	75	150.5	152	105	56.5	28	175	36	20	170	162	64	50	M8×1.25	ø9	119	20	20	151	ø9, ø14×8.5 dp	74	ø6H7×20 dp

MEGTB / U Dimensions 32~63

TWIN-GUIDED ELECTRIC ACTUATOR (WITHOUT MOTOR)



MEGTB (Brass bush guide)

MEGTU (Linear bearing guide)

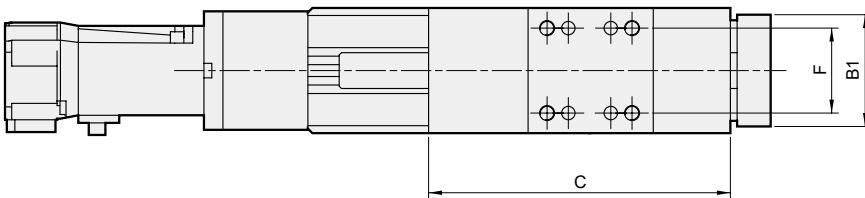

BC

Motor direct connection

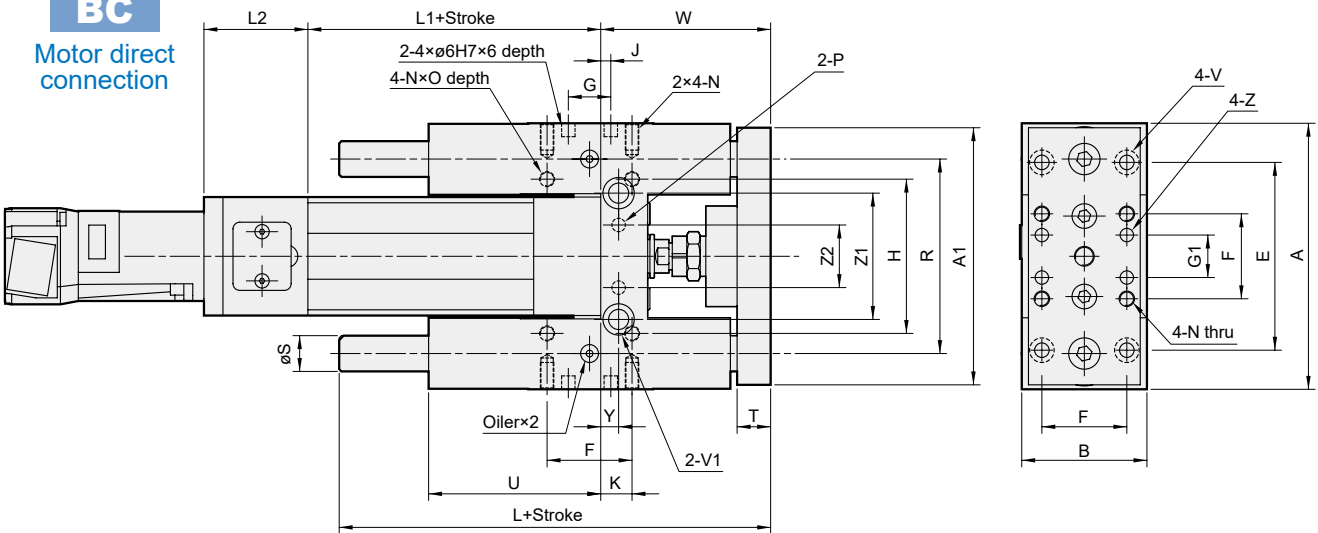

BA

Motor Turned

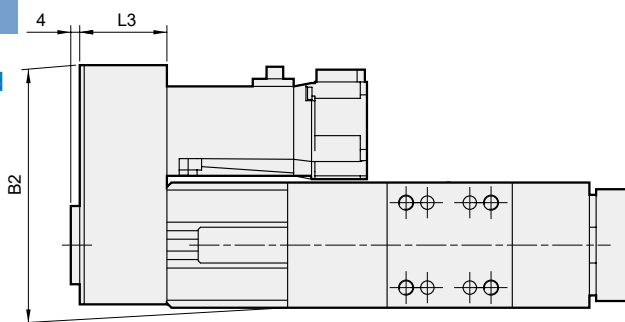

Size 32

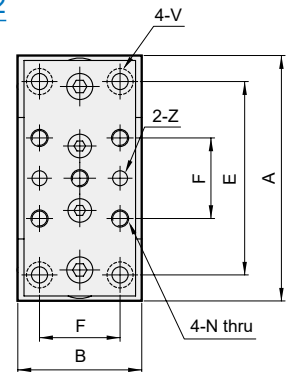

Code Size	A	A1	B	B1	B2	C	E	F	G	G1	H	J	K	L	L1	L2	L3	N	O	P	R	S	T	U
32	99	95	50	45	100.5	120	78	32.5	16	-	61	5.7	14	179	87	51	42	M6×1.0	12	ø6H7×6 dp	74	12	15	67
40	119	115	56	50	108.5	135	84	38	19	19	69	4.5	14	193	131	46.5	39	M6×1.0	12	ø6H7×6 dp	87	16	15	77
50	141	135	70	65	145.5	150	100	46.5	23	23	85	7.5	19	216	152	59.5	50	M8×1.25	14	-	104	20	20	81
63	156	150	80	75	152	165	105	56.5	28	28	100	5	19	230	162	64	50	M8×1.25	16	-	119	20	20	96

Code Size	V	V1	W	Y	Z	Z1	Z2
32	ø6.5, ø10.5×6.5 dp	ø9, ø14×5 dp	72	8	ø6H7×15 dp	46.5	23
40	ø6.5, ø11×6.5 dp	ø9, ø14×5 dp	76	8	ø6H7×15 dp	56.5	28
50	ø9, ø14×8.5 dp	-	94	-	ø6H7×20 dp	-	-
63	ø9, ø14×8.5 dp	-	94	-	ø6H7×20 dp	-	-

MEGT* Rear flange coupling 32~63

TWIN-GUIDED ELECTRIC ACTUATOR (WITHOUT MOTOR)



Mindman

MEGTX

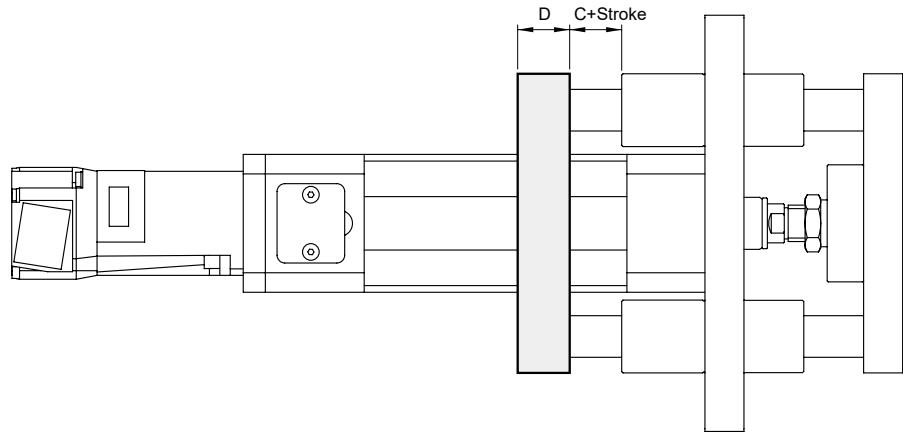
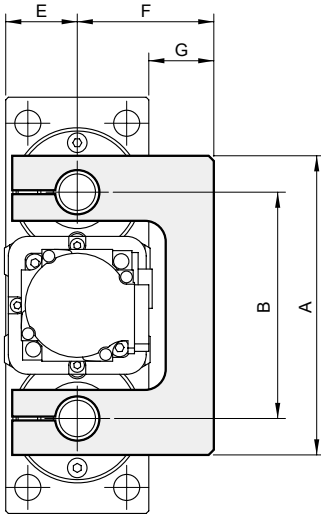

MEGTB

MEGTU

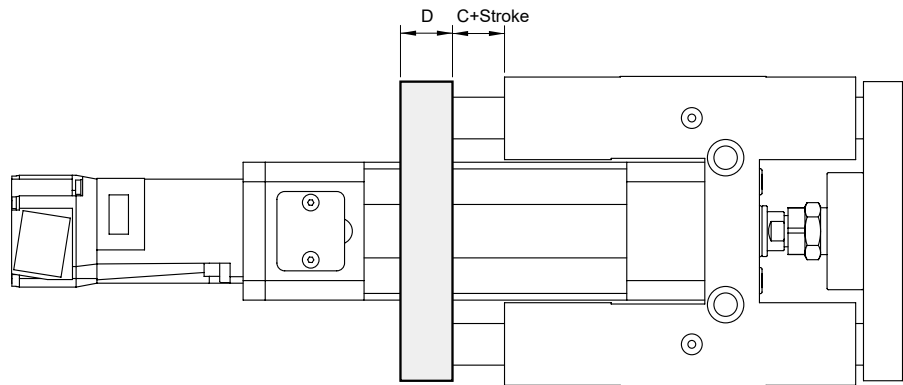
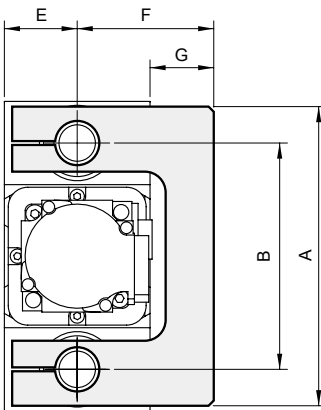

Code Size	A	B	C	D	E	F	G
32	95	74	25	15	25	47	22
40	115	87	20	20	28	52.5	24.5
50	135	104	20	20	35	67.5	32.5
63	150	119	20	20	40	78	38

* MEGTX-40: E=27.5, G=25

* MEGTB-50: C=21