

MEQYC-65L series

ROD ELECTRIC CYLINDER - BALL SCREW DRIVE (WITH MOTOR)

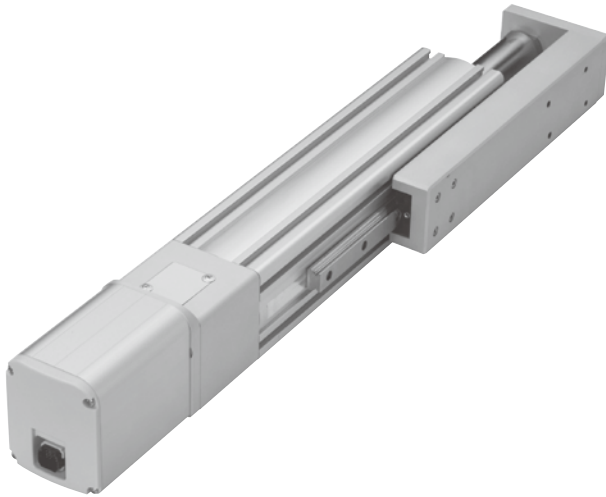

Specification

| Model | MEQYC-65L | | | |
|---------------------------------|-------------------|-----|------|----|
| Repeatability (mm) | ±0.01 | | | |
| Ball screw lead (mm) | 5 | 10 | 20 | |
| Maximum speed (mm/s) (*1) | 250 | 500 | 1000 | |
| Maximum payload | Horizontal (kg) | 110 | 88 | 40 |
| | Vertical (kg) | 30 | 20 | 10 |
| Rated thrust (N) | 791 | 395 | 197 | |
| Stroke / pitch (mm) (*2) | 50~500 / 50 Pitch | | | |
| Motor dimension (mm) | □56 | | | |
| Ball screw spec (mm) | C7ø16 | | | |
| Anti-rotating accuracy (θ) (*3) | ±0.05° | | | |

*1. The maximum speed shown here is when software speed setting is 100%.

*2. When the stroke is over 300mm, the run-out of the ball screw will occur. We recommend to low down the working speed under this circumstances.

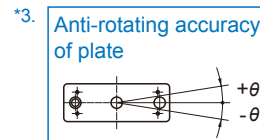

Order example of cylinder

MEQYC-65L — **L05** — **100** — **M** — **TC100** — **03** — **A0001**

| | | | | | |
|-------------------------|--|---------------------------------|---|--|--|
| Model | Spec. | | | | Special order no. |
| Ball screw brand | Ball screw lead | Stroke | Motor position | Corresponding controller | Cable length |
| L T-Standard MIT | 05 5 mm 10 10 mm 20 20 mm | 50~500 mm 50 mm pitch | M Built-in BM On lower side BR On right side BL On left side | TC100 * Please refer to 4-118. | 01 1 m 03 3 m 05 5 m 10 10 m * Standard: 3 m |

Order example of controller

TC100 — **03**

| | |
|-------------------|---------------------|
| Controller | Cable length |
| TC100 | Blank No cable |
| | 01 1 m |
| | 03 3 m |
| | 05 5 m |
| | 10 10 m |

* Standard: 3 m

Speed-payload curve diagram

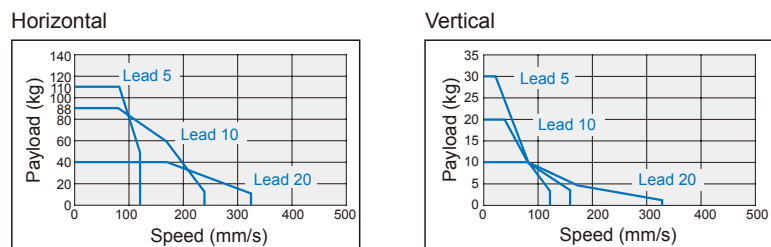

MEQYC-65L Dimensions

ROD ELECTRIC CYLINDER - BALL SCREW DRIVE (WITH MOTOR)



M

Motor built-in

A-A

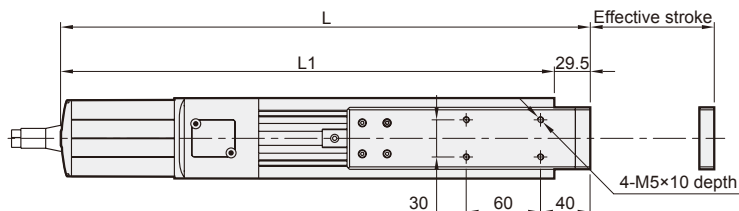
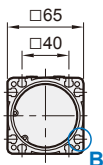

B view

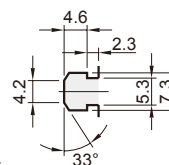

(min. 100 for the space of cable connection)

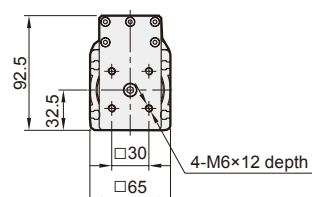
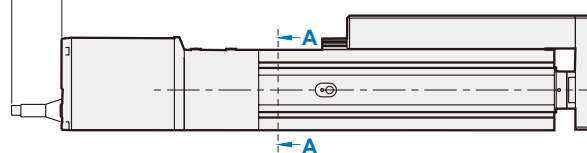

Unit: mm

| Stroke | 50 | 100 | 150 | 200 | 250 | 300 | 350 | 400 | 450 | 500 |
|-----------|-------|-------|-------|-------|-------|-------|-------|-------|-------|-------|
| L | 377.5 | 427.5 | 477.5 | 527.5 | 577.5 | 627.5 | 677.5 | 727.5 | 777.5 | 827.5 |
| L1 | 348.5 | 398.5 | 448.5 | 498.5 | 548.5 | 598.5 | 648.5 | 698.5 | 748.5 | 798.5 |
| KG | 5.5 | 5.76 | 6.02 | 6.28 | 6.53 | 6.79 | 7.05 | 7.31 | 7.57 | 7.82 |

BM

Motor on lower side

A-A

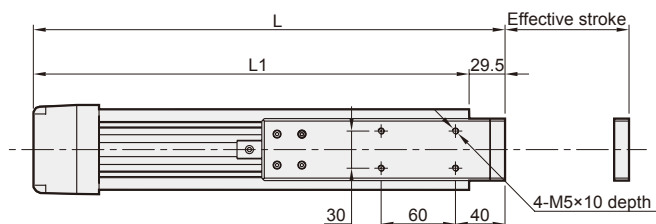
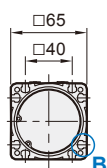

B view

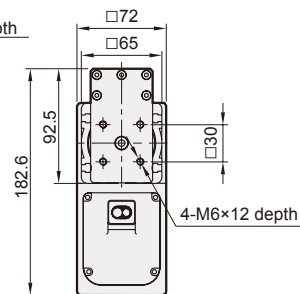
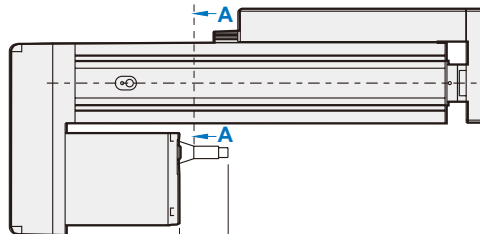
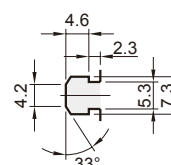

(min. 100 for the space of cable connection)

Unit: mm

| Stroke | 50 | 100 | 150 | 200 | 250 | 300 | 350 | 400 | 450 | 500 |
|-----------|-------|-------|-------|-------|-------|-------|-------|-------|-------|-------|
| L | 270.5 | 320.5 | 370.5 | 420.5 | 470.5 | 520.5 | 570.5 | 620.5 | 670.5 | 720.5 |
| L1 | 241 | 291 | 341 | 391 | 441 | 491 | 541 | 591 | 641 | 691 |
| KG | 6 | 6.26 | 6.52 | 6.78 | 7.03 | 7.29 | 7.55 | 7.81 | 8.07 | 8.32 |

MEQYC-65L Dimensions

ROD ELECTRIC CYLINDER - BALL SCREW DRIVE (WITH MOTOR)



BR

Motor on right side

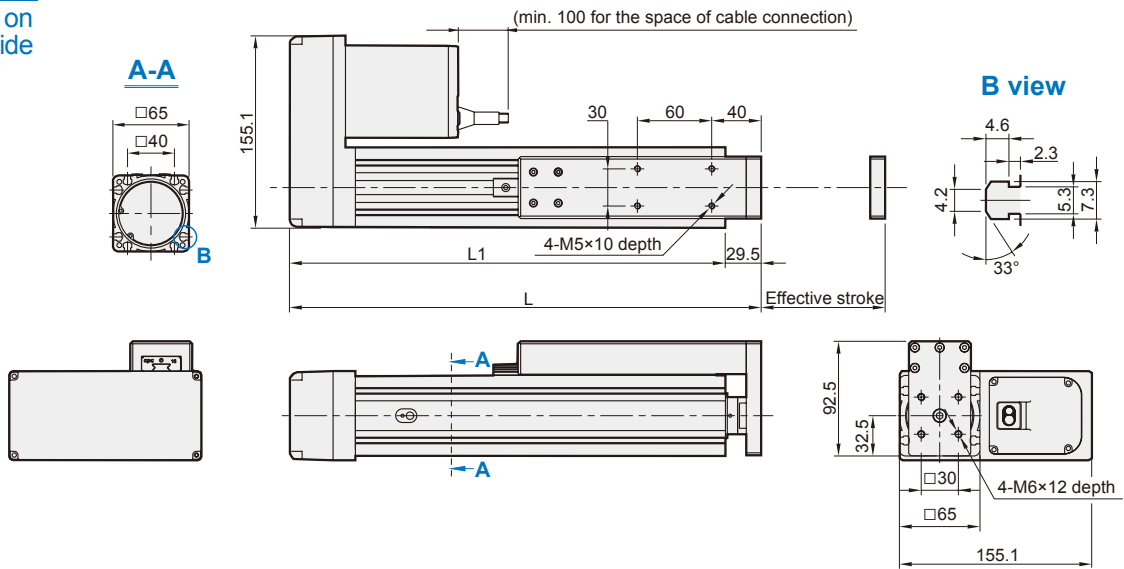

Unit: mm

| Stroke | 50 | 100 | 150 | 200 | 250 | 300 | 350 | 400 | 450 | 500 |
|-----------|-------|-------|-------|-------|-------|-------|-------|-------|-------|-------|
| L | 270.5 | 320.5 | 370.5 | 420.5 | 470.5 | 520.5 | 570.5 | 620.5 | 670.5 | 720.5 |
| L1 | 241 | 291 | 341 | 391 | 441 | 491 | 541 | 591 | 641 | 691 |
| KG | 6 | 6.26 | 6.52 | 6.78 | 7.03 | 7.29 | 7.55 | 7.81 | 8.07 | 8.32 |

BL

Motor on left side

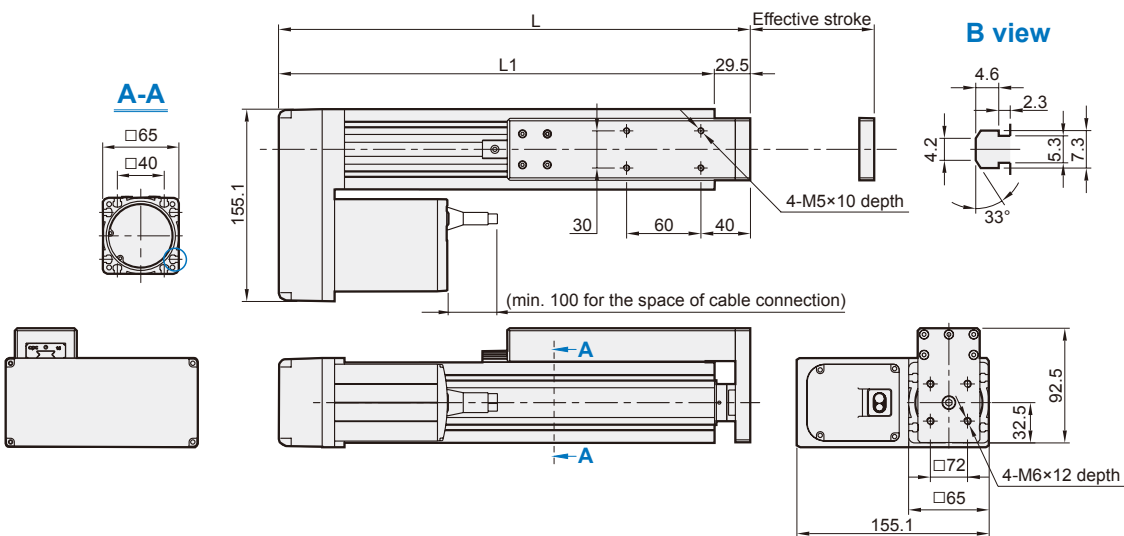

Unit: mm

| Stroke | 50 | 100 | 150 | 200 | 250 | 300 | 350 | 400 | 450 | 500 |
|-----------|-------|-------|-------|-------|-------|-------|-------|-------|-------|-------|
| L | 270.5 | 320.5 | 370.5 | 420.5 | 470.5 | 520.5 | 570.5 | 620.5 | 670.5 | 720.5 |
| L1 | 241 | 291 | 341 | 391 | 441 | 491 | 541 | 591 | 641 | 691 |
| KG | 6 | 6.26 | 6.52 | 6.78 | 7.03 | 7.29 | 7.55 | 7.81 | 8.07 | 8.32 |