

MESH2-16 series

MINIATURE ELECTRIC CYLINDER (WITH MOTOR)



Specification

Model	MESH2-16	
Positioning repeatability (mm)	±0.02	
Screw lead (mm)	2	
Maximum speed (mm/s) *1	≤50	
Maximum work load *2	Horizontal (kg)	3
	Vertical (kg)	0.8
Pushing force 50~80%(N) *1,3	35 ~ 56	
Pushing speed (mm/s)	1 ~ 45	
Stroke (mm)	30 / 50	
Motor dimension (mm)	□20	

*1. The speed and force may change depending on the cable length, load and mounting conditions.

*2. The maximum load capacity decreases as the speed increases.

*3. The accuracy of pushing force is ± 20%.

Motor type	Step motor	Actuation type	Ball screw
Use environment	Standard	Guide type	Linear guideway

Order example (Produce after received your orders)

MESH2 – 16 L02 – 30 – CQ1 03 N 01 – XA00

Model	Spec.	Stroke	I/O type	I/O cable length	Controller / Driver	Actuator cable length
MESH2	Ball screw lead L02 2 mm	30 30 mm 50 50 mm	N NPN	01 1 m 03 3 m <small>* Standard: 1 m</small>	CQ1 MECQ1 CP MECP <small>* Standard: MECQ1 * Please refer to page 4-89.</small>	01 1 m 03 3 m 05 5 m <small>* Standard: 3 m</small>

Special order no. XA00

Speed-work load curve diagram

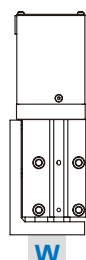
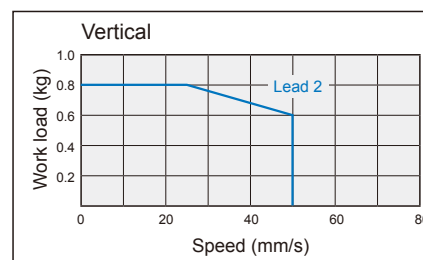
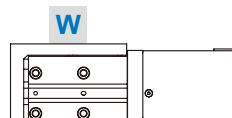
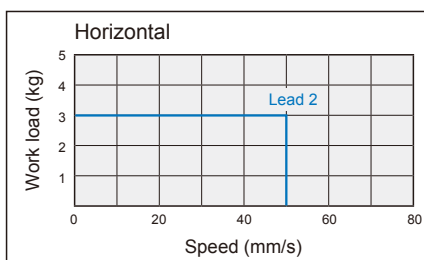

MESH2-16 Dimensions

MINIATURE ELECTRIC CYLINDER (WITH MOTOR)

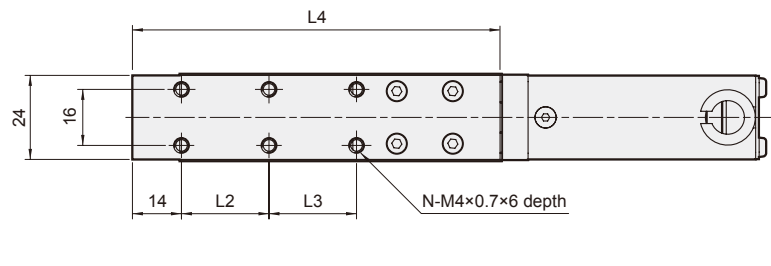

A view

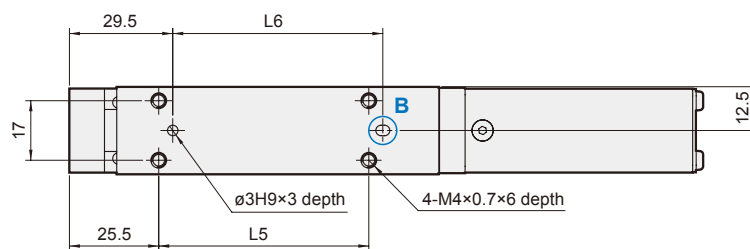
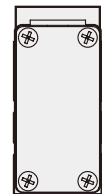
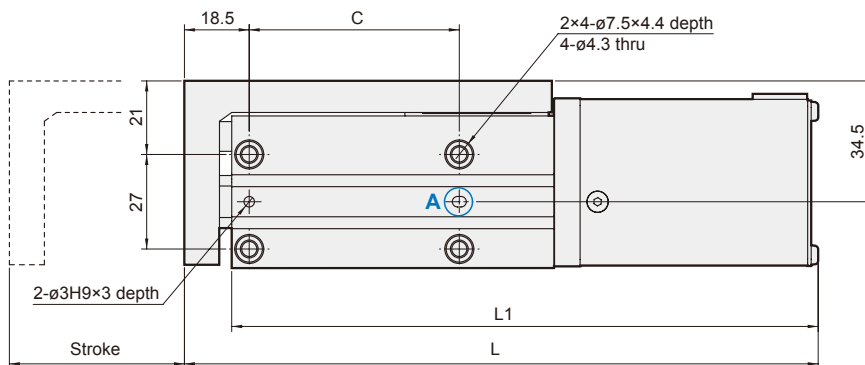
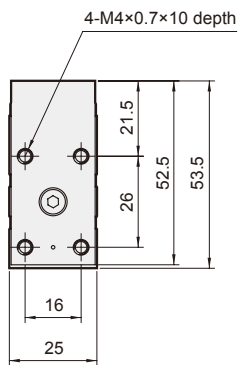
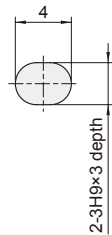

B view

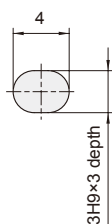

Unit: mm



Stroke	C	L	L1	L2	L3	L4	L5	L6	N	Weight (g)
30	40	161	147.5	30	-	85	40	40	4	500
50	60	181	167.5	25	25	105	60	60	6	562

Controller list

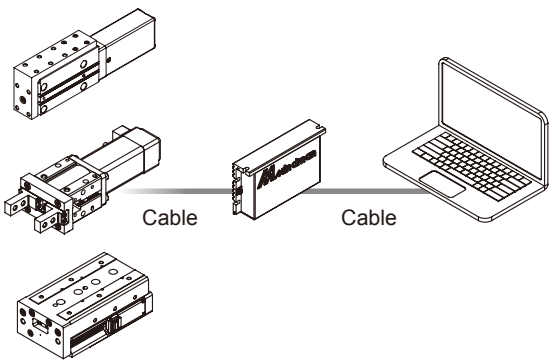

ELECTRIC GRIPPER (WITH MOTOR)

mindman

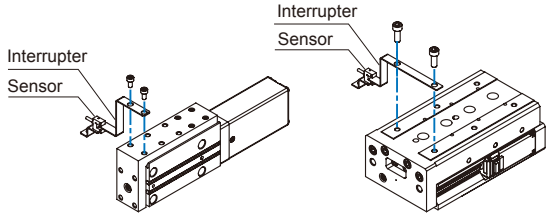
Drive model	Type	Specification	Exterior	Original setting method
MECQ1	Communication (485 & I/O)	24VDC±10% max. 500mA (Except motor current)		 <p>Directly set origin from software</p>
MECP	Pulse input			 <p>Require external sensor to set origin. * Sensor and interrupter have to extra purchase.</p>

Accessories

Order example	Description
MECQ1-20L-N	□ 20 Step motor controller (Communication)
MECQ1-28L-N	□ 28 Step motor controller (Communication)
MECQ1-P	Controller power adapter
MECQ1-M01	Actuator cable length - 1M *1
MECQ1-M03	Actuator cable length - 3M *1
MECQ1-M05	Actuator cable length - 5M *1
MECQ1-S01	I/O signal cable - 1M (26Pin)
MECQ1-S03	I/O signal cable - 3M (26Pin)
MECP-20L-N	□ 20 Step motor driver (Pulse input) *2
MECP-28L-N	□ 28 Step motor driver (Pulse input) *2
MECP-P	Driver power adapter
MECP-C	Parameter setting adapter (Pulse input)
MECP-S01	I/O signal cable - 1M (20Pin)
MECP-S03	I/O signal cable - 3M (20Pin)
ESH216-1	MESH2-16 interrupter
ESH220-1	MESH2-20 interrupter
ESS216-1	MESS2-16 interrupter
ESS225-1	MESS2-25 interrupter
EE-SX952-C1J-R	Sensor

*1. Shared with MECP.

*2. Not suitable for MEHC2 series.

Dimension of sensor interrupter

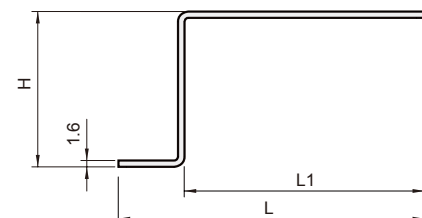
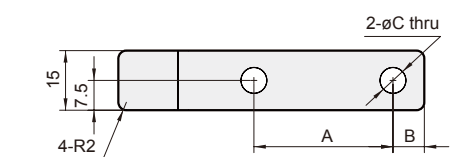

Code Model	A	B	C	H	L	L1
ESH216-1	16	3.9	6	41.6	45	28.4
ESH220-1	20	4.4	6	41.6	51	34.4
ESS216-1	35	7.9	6.5	39.1	77	60.4
ESS225-1	56	7.4	6.5	39.1	102	85.4