

# MESH2-20 series

## MINIATURE ELECTRIC CYLINDER (WITH MOTOR)

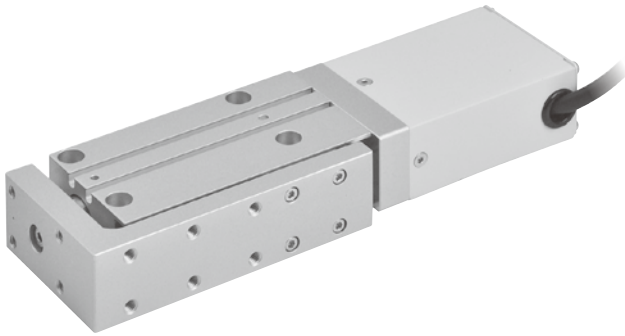

### Specification

Model	MESH2-20	
Positioning repeatability (mm)	±0.02	
Screw lead (mm)	2	8
Maximum speed (mm/s) *1	≤100	≤400
Maximum work load *2	Horizontal (kg)	6
	Vertical (kg)	1.5
Pushing force 50~80%(N) *1,3	100 ~ 160	25 ~ 40
	25 ~ 40	
Pushing speed (mm/s)	1 ~ 45	
Stroke (mm)	30 / 50	
Motor dimension (mm)	□28	

\*1. The speed and force may change depending on the cable length, load and mounting conditions.

\*2. The maximum load capacity decreases as the speed increases.

\*3. The accuracy of pushing force is ± 20%.

Motor type    Step motor    Actuation type    Ball screw

Use environment    Standard    Guide type    Linear guideway

### Order example (Produce after received your orders)

**MESH2 - 20 L02 - 30 - CQ1 03 N 01 - XA00**

Model

Spec.

Special order no.

Ball screw lead

L02	2 mm
L08	8 mm

Stroke

30	30 mm
50	50 mm

I/O type

N	NPN
---	-----

I/O cable length

01	1 m
03	3 m

\* Standard: 1 m

Controller / Driver

CQ1	MECQ1
CP	MECP

\* Standard: MECQ1

\* Please refer to page 4-89.

Actuator cable length

01	1 m
03	3 m
05	5 m

\* Standard: 3 m

### Speed-work load curve diagram

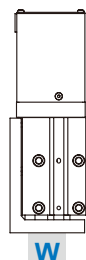
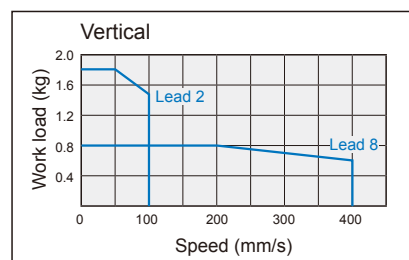
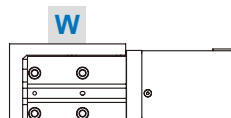
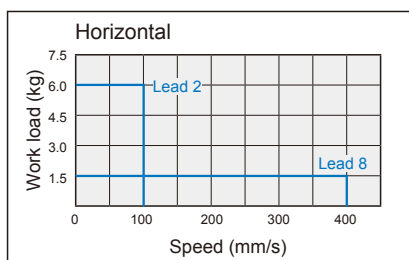

# MESH2-20 Dimensions

## MINIATURE ELECTRIC CYLINDER (WITH MOTOR)



Mindman

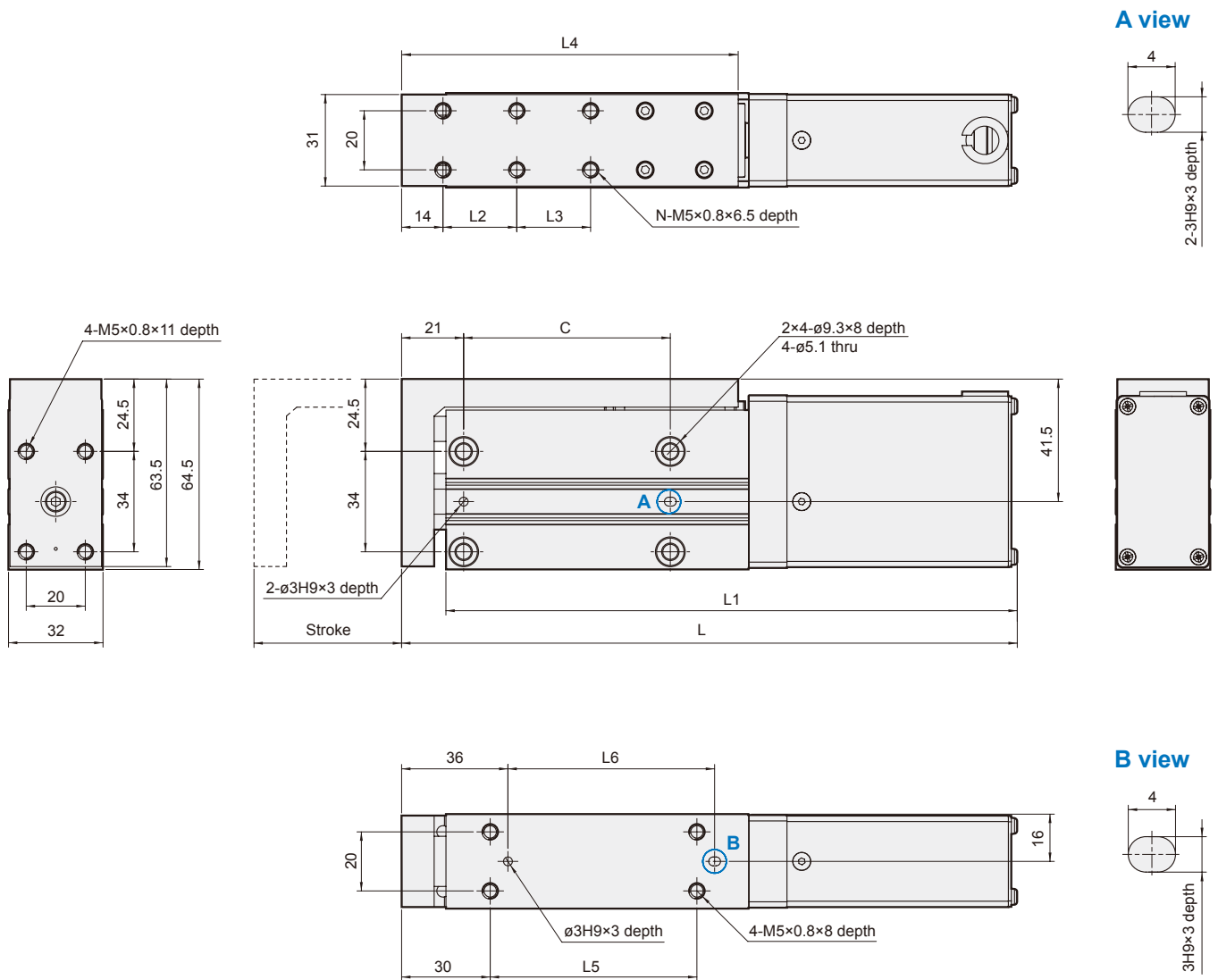

Unit: mm



Stroke	C	L	L1	L2	L3	L4	L5	L6	N	Weight (g)
30	40	188.5	173.5	30	-	97	40	40	4	950
50	70	208.5	193.5	25	25	114	70	70	6	1049

# Controller list

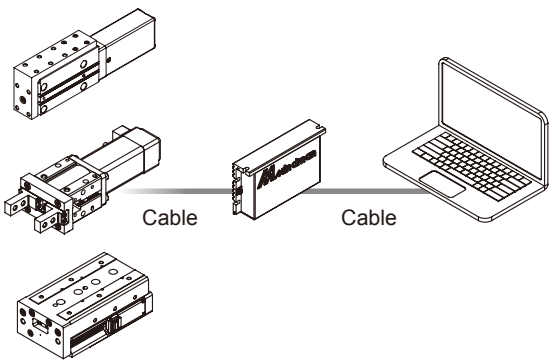

## ELECTRIC GRIPPER (WITH MOTOR)

mindman

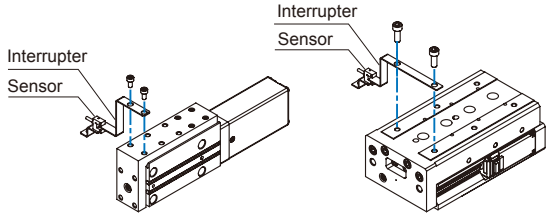
Drive model	Type	Specification	Exterior	Original setting method
MECQ1	Communication (485 & I/O)	24VDC±10% max. 500mA (Except motor current)		 <p>Directly set origin from software</p>
MECP	Pulse input			 <p>Require external sensor to set origin. * Sensor and interrupter have to extra purchase.</p>

### Accessories

Order example	Description
MECQ1-20L-N	□ 20 Step motor controller (Communication)
MECQ1-28L-N	□ 28 Step motor controller (Communication)
MECQ1-P	Controller power adapter
MECQ1-M01	Actuator cable length - 1M *1
MECQ1-M03	Actuator cable length - 3M *1
MECQ1-M05	Actuator cable length - 5M *1
MECQ1-S01	I/O signal cable - 1M (26Pin)
MECQ1-S03	I/O signal cable - 3M (26Pin)
MECP-20L-N	□ 20 Step motor driver (Pulse input) *2
MECP-28L-N	□ 28 Step motor driver (Pulse input) *2
MECP-P	Driver power adapter
MECP-C	Parameter setting adapter (Pulse input)
MECP-S01	I/O signal cable - 1M (20Pin)
MECP-S03	I/O signal cable - 3M (20Pin)
ESH216-1	MESH2-16 interrupter
ESH220-1	MESH2-20 interrupter
ESS216-1	MESS2-16 interrupter
ESS225-1	MESS2-25 interrupter
EE-SX952-C1J-R	Sensor

\*1. Shared with MECP.

\*2. Not suitable for MEHC2 series.

### Dimension of sensor interrupter

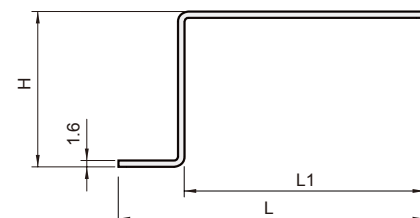
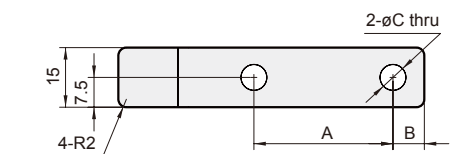

Code Model	A	B	C	H	L	L1
ESH216-1	16	3.9	6	41.6	45	28.4
ESH220-1	20	4.4	6	41.6	51	34.4
ESS216-1	35	7.9	6.5	39.1	77	60.4
ESS225-1	56	7.4	6.5	39.1	102	85.4