

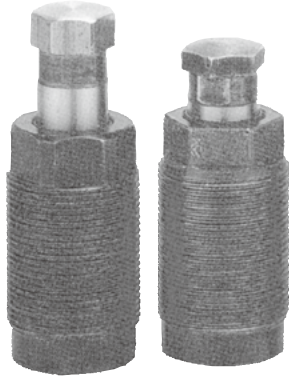

Caution for safety  
(Read before installing)



### Features

- Hydraulic work support is used to both minimise vibration during machining and offer increased support.
- A type unit works on the outward stroke with a internal spring.
- B type unit works with oil pressure providing the motive force.

### Specification

Model	MSP-16A	MSP-16B
Normal operating pressure	10~35 MPa	
Cylinder operating	Single-acting	
Piston $\phi$ (mm)	16	
Stroke (mm)	8	
Theoretical force (20 MPa)	210 kg	

#### MSP-16A

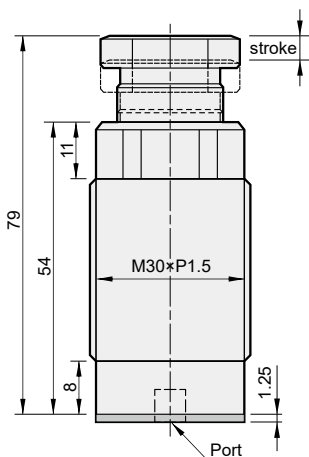

#### MSP-16B

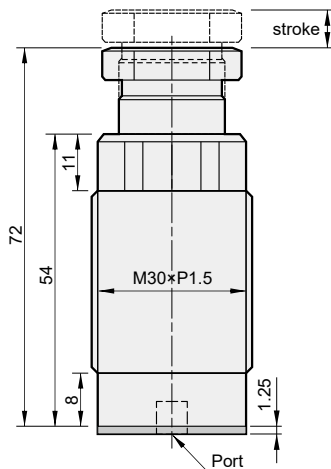

#### Mounting diagram

