



Selection table



MU* Reference table



Seal material



Caution for safety
(Read before installing)

2-WAY normally closed solenoid valve.
Available fluid: Water, air, & oil.



2/2 N.C.

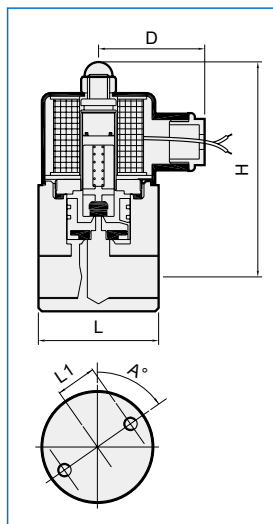

Specification

- Multiplex acting, piston guide, conductive normal close.
- AC voltage tolerance: $\pm 10\%$
DC voltage tolerance: $\pm 1\%$
- Applied to sand blasting machine and high-pressure air and oil injection system.

Material

Parts name	Material
Body	Brass
Coil	Special copper wire (H class)
Tube	Stainless steel
Spring	Stainless steel
Core	Stainless steel
Plug	NBR
Piston	Brass
Piston plug	NBR

Caution

- Min pressure to open: over 0.05 MPa
- Before pipelining, the pipe line must be very clean without any contaminants or impurity.
- To extend the lifetime, Y-line filter should be installed in the front end of solenoid valve.
- It should be installed horizontally; vertical installation is not advisable.

Not for fluid of

- Liquid when heat, solid when cool.
- Corrosive fluid.
- Viscosity over 50 cst.
- Temperature over 80°C.

Order example

MUAO — 8 — □ — HO — AC110 — G

MODEL

PORT SIZE

8: 1/4"
10: 3/8"
15: 1/2"

FLUID

W: Water, air
HO: Heavy oil (*2)

COIL

Blank: Standard iron shell coil
D: DIN terminal (under 130°C) (*1)
I: Waterproof terminal (under 130°C) (*1)

VOLTAGE

AC220V(50/60)Hz
AC110V(50/60)Hz
DC24V

PORT THREAD

Blank: Rc thread
G: G thread
NPT: NPT thread

*1. Please order according to the specification sheet.
*2. Please indicate the kind.

Model	D / I coil	Port size	CV	Orifice (mm)	Fluid temp. °C	Operating pressuer range (MPa)			Dimensions (mm)						Weight (kg)
						Water	Air	Heavy oil	L	H	D	L1	A	M	
MUAO-8	•	Rc1/4"	2.5	10	-5~+80	0.05~1.5	0.05~1.5	0.05~1.5	50	95	48	18	55°	M6×1.0	1.13
MUAO-10	•	Rc3/8"	2.5	10	-5~+80	0.05~1.5	0.05~1.5	0.05~1.5	50	95	48	18	55°	M6×1.0	1.10
MUAO-15	•	Rc1/2"	2.5	10	-5~+80	0.05~1.5	0.05~1.5	0.05~1.5	54	100	48	18	55°	M6×1.0	1.23

* Please consult your sales representative for other customization requirement.