



### Tabla para carrera estándar

D.I. Tubo	Carrera (pulgadas)	Carrera larga (pulgadas)	Máx. carrera (pulgadas)
20: 3/4"	1, 2, 3, 4, 5, 6, 8	8.01~14	48
25: 1"	1, 2, 3, 4, 5, 6, 8, 10, 12	12.01~16	
32: 1 1/4"		12.01~18	
40: 1 1/2"		12.01~32	
50: 2"		12.01~48	
63: 2 1/2"		12.01~19	19

\* Carrera intermedia disponible, consúltenos.

### Especificaciones

Modelo		MCCN					
Tipo de acción		Doble efecto					
D.I. Tubo (pulgadas)		3/4"	1"	1 1/4"	1 1/2"	2"	2 1/2"
Tam. puerto		NPT1/8			NPT1/4		
Medio		Aire					
Presión de funcionamiento máx.		1 MPa					
Presión de funcionamiento mín.		0.05 MPa					
Presión de prueba		1.5 MPa					
Lubricación		No requerida					
Temperatura ambiente		-5~+60°C (Sin congelación)					
Rango de velocidad disponible		50~500 mm/seg.					
Energía cinética máx. admisible (J)	Amortiguación elástica	0.07	0.10	0.17	0.3	0.5	0.85
	Amortiguación neumática	0.09	0.14	0.23	0.45	0.85	1.23
Sensor final de carrera		RCM (Consulte la página 8-16)					
Abrazadera del sensor final de carrera		BMG20	BMG25	BMG32	BMG40	BMG50	BMG63

### Ejemplo de pedido

## MCCN – 11 – 40 – 0425M – A

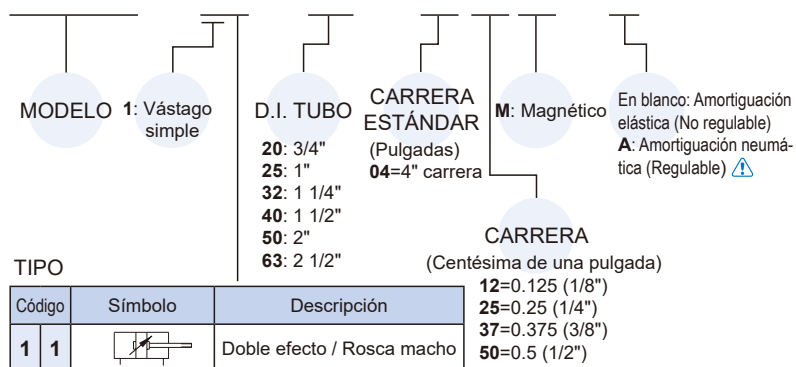

### ⚠ Precaución

Para (A) Amortiguación neumática (regulable)

- Para ajustar el tornillo de amortiguación, gire la válvula de aguja del estado completamente cerrado hacia el estado requerido cuyos giros deben estar dentro de 2.5 etapas.
- Si la válvula de aguja se afloja excesivamente, el tope no puede surtir efecto y la vida útil del cilindro puede acortarse.

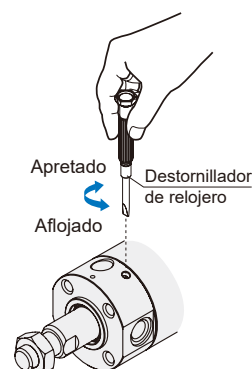





\* Consulte la pág. 0-7 para ver un ejemplo de pedido con especificaciones especiales.

\* Consulte la página 3-84 para ver un ejemplo de pedido de componentes y kits de reparación.

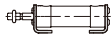
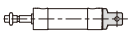
## CILINDRO REDONDO

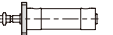
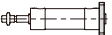
### ■ Accesorios de montaje

Accesorios					
Código	LB (Compra 2 piezas)	CA	CB	FAC	FBC
Montaje D.I. tubo					
20: 3/4"	<b>LB-C2-20</b>	<b>CA-C2-20</b>	<b>CB-C2-20</b>	<b>FAC-C2-20</b>	
25: 1"	<b>LB-C2-25</b>	<b>CA-C2-25</b>	<b>CB-C2-25</b>	<b>FAC-C2-25</b>	
32: 1 1/4"	<b>LB-C2-32</b>	<b>CA-C2-32</b>	<b>CB-C2-32</b>	<b>FAC-C2-32</b>	
40: 1 1/2"	<b>LB-C2-40</b>	<b>CA-C2-40</b>	<b>CB-C2-40</b>	<b>FAC-C2-40</b>	
50: 2"	<b>LB-C2-50</b>	<b>CA-C2-50</b>	<b>CB-C2-50</b>	<b>FAC-C2-50</b>	
63: 2 1/2"	<b>LB-C2-63</b>	<b>CA-C2-63</b>	<b>CB-C2-63</b>	<b>FAC-C2-63</b>	

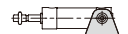
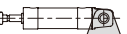
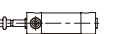
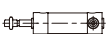
Accesorios					
Código	SDB-R* <sup>1</sup> (con TA)	SDB-H* <sup>1</sup> (con TB)	CB+SDB* <sup>1</sup> (con Pasador)	TA (Muñón parte delantera)	TB (Muñón parte trasera)
Montaje D.I. tubo					
20: 3/4"	<b>SDB-C1-20</b>		<b>CB+SDB-C2-20</b>	<b>TA-C1-20</b>	
25: 1"	<b>SDB-C1-25</b>		<b>CB+SDB-C2-25</b>	<b>TA-C1-25</b>	
32: 1 1/4"	<b>SDB-C1-32</b>		<b>CB+SDB-C2-32</b>	<b>TA-C1-32</b>	
40: 1 1/2"	<b>SDB-C1-40</b>		<b>CB+SDB-C2-40</b>	<b>TA-C1-40</b>	
50: 2"	<b>SDB-C1-50</b>		<b>CB+SDB-C2-50</b>	<b>TA-C1-50</b>	
63: 2 1/2"	<b>SDB-C1-63</b>		<b>CB+SDB-C2-63</b>	<b>TA-C1-63</b>	

\*1. Consulte la pág. 3-90 para los procedimientos de montaje.

### ■ Pasador

Tuerca del vástago	
Código	NUT
Montaje D.I. tubo	
20: 3/4"	<b>NUT-1/4-28UNFx0.16Hx0.44B</b>
25: 1"	<b>NUT-5/16-24UNFx0.19Hx0.5B</b>
32: 1 1/4"	<b>NUT-7/16-20UNFx0.26Hx0.69B</b>
40: 1 1/2"	
50: 2"	<b>NUT-1/2-20UNFx0.32Hx0.75B</b>
63: 2 1/2"	

Aplicable	Accesorios CB
Código	PIN-CB-P (Con anillo elástico)
Higo D.I. tubo	
20: 3/4"	<b>PIN-C1-20-1-P</b>
25: 1"	<b>PIN-C1-25-1-P</b>
32: 1 1/4"	<b>PIN-C1-32-1-P</b>
40: 1 1/2"	<b>PIN-C1-40-1-P</b>
50: 2"	<b>PIN-C1-50-1-P</b>
63: 2 1/2"	<b>PIN-C1-63-1-P</b>

### Amortiguación elástica No regulable

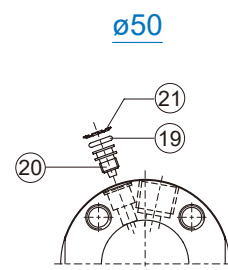
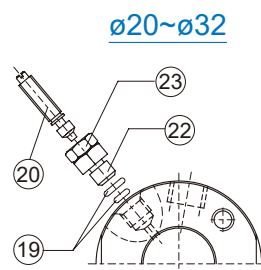
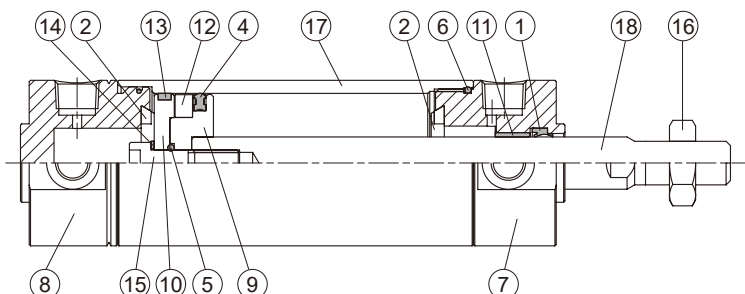

### Amortiguación neumática Regulable

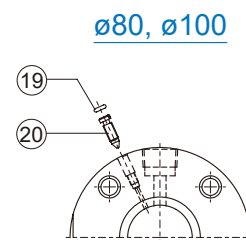
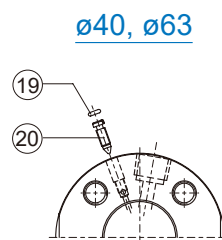
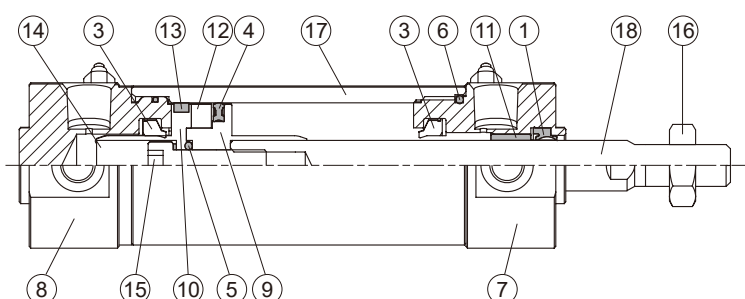

### Material

A: Componentes, B: Kits de reparación

Núm.	Amortiguación		Nombre de la pieza	Material	Cant.	A B		Notas
	Elástica	Aire				(incluidos)		
1	●	●	Juntas del vástago	NBR	1	●	●	
2	●	●	Amortiguación elástica	NBR	2	●	●	
3	●	●	Amortiguación elástica	NBR	2	●	●	
4	●	●	Juntas del pistón	NBR	1	●	●	
5	●	●	Junta tórica	NBR	1	●	●	
6	●	●	Junta tórica	NBR	1 o 2	●	●	ø50~100 (Cant.=2)
7	●	●	Cubierta del vástago	Aleación de aluminio	1	●		
8	●	●	Culata	Aleación de aluminio	1	●		
9	●	●	Pistón-R	Aleación de aluminio	1	●		
10	●	●	Pistón H	Aleación de aluminio	1	●		
11	●	●	Casquillo	Aleación de cojinete	1	●		
12	●	●	Anillo magnético	Material magnético	1	⊙		⊙ Opcional
			Anillo espaciador	Aleación de aluminio	1	●		para ø20~ø32
13	●	●	Anillo de desgaste	Resina	1	●		
14	●	●	Arandela	Acero al carbono	1	●		ø20 sin
15	●	●	Tornillo del pistón	Acero al carbono	1	●		
16	●	●	Tuerca	Acero al carbono	1	●		
17	●	●	Tubo cilíndrico	Aleación de aluminio	1			
18	●	●	Vástago del pistón	Acero al carbono	1			ø20-25 acero inoxidable
19	●	●	Junta tórica	NBR	4 o 2			ø40-80 (Cant.=2)
20	●	●	Válvula de aguja	Acero inoxidable	2			*1
21	●	●	Juntas válvula de aguja	Acero al carbono	2			Solo para ø50
22	●	●	Tuerca fija de la válvula de aguja	Acero inoxidable	2			solo para ø20-32
23	●	●	Tuerca hex.	Acero al carbono	2			solo para ø20-32

\*1. ø50: Cobre, ø63~100: Acero al carbono

### Ejemplo de pedido de componentes

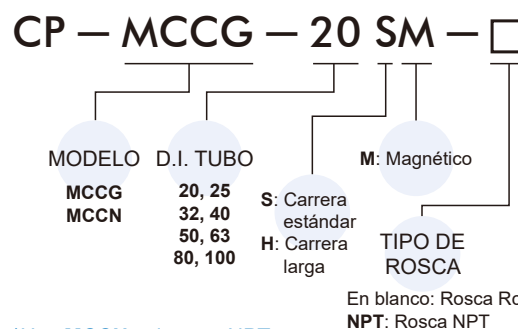

\*Use MCCN solo para NPT.  
\* Por favor consúltenos para el ejemplo de pedido de la rosca G.

### Ejemplo de pedido de kits de reparación

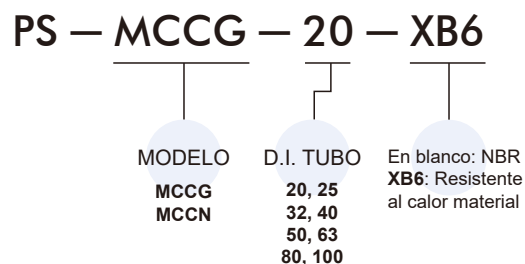

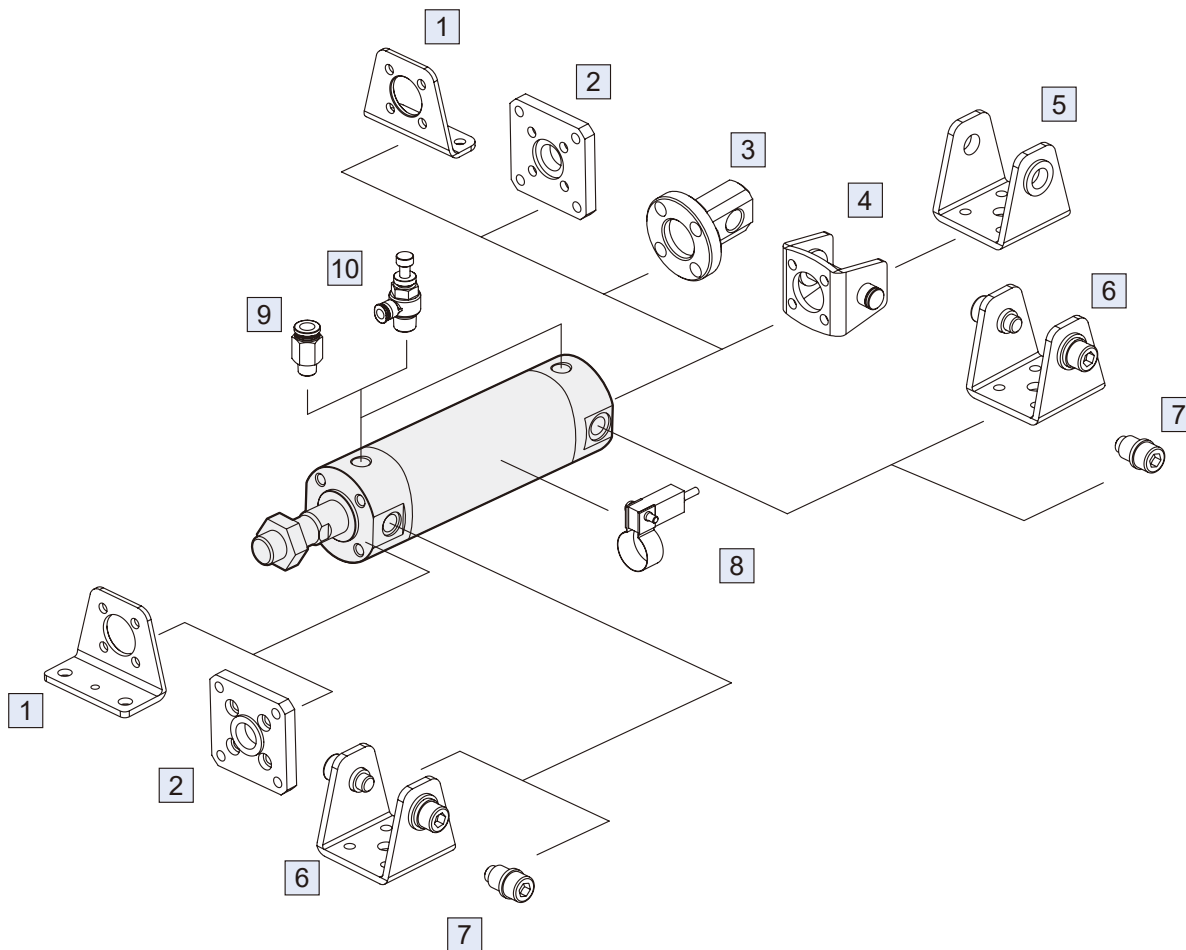

Núm.	Accesorios	Material	Pág.
1	Accesorios de montaje LB	Acero al carbono	3-95
2	Accesorios de montaje FAC/FBC	Acero al carbono	3-95
3	Accesorios de montaje CA	Acero al carbono	3-96
4	Accesorios de montaje CB+PIN	Acero al carbono	3-96, 98, 90
5	Accesorios de montaje SDB	Acero al carbono	3-97, 90
6	Accesorios de montaje SDB-R/H	Acero al carbono	3-97, 90
7	Accesorios de montaje TA/TB	Acero al carbono	3-98
8	Sensor final de carrera RCM+BMG**	—	8-16
9	Racor PC (PISCO)	—	7-3 (Vol.1)
10	Controlador de velocidad JSC (PISCO)	—	7-15 (Vol.1)

CILINDRO REDONDO

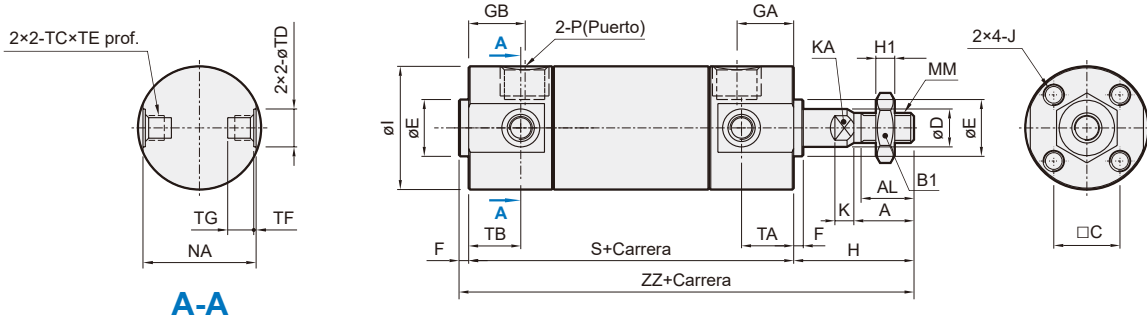

A-A

Amortiguación neumática (Regulable)

A

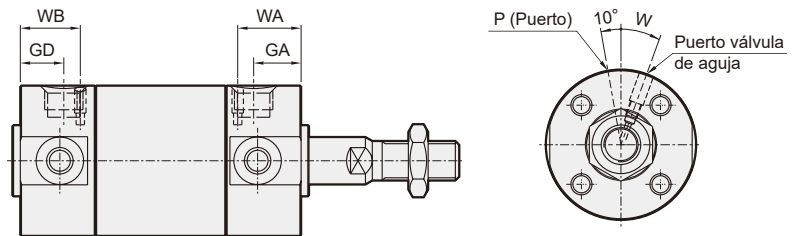

Unidad: pulgadas

Código D.I. Tubo	Rango de carrera estándar	Rango de carrera larga	A	AL	B1	C	D	E	F	GA	GB	GD	H	H1	I	J	K
20	~ 8	8.01 ~ 14	0.50	0.44	0.44	0.55	0.315	0.472 <sup>+0 -0.002</sup>	0.08	0.47	0.47 (0.47)	0.47 (0.47)	1	0.16	1.02	#8-32x0.28 prof.	0.157
25	~12	12.01 ~ 16	0.50	0.44	0.50	0.65	0.394	0.551 <sup>+0 -0.002</sup>	0.08	0.47	0.47 (0.47)	0.47 (0.47)	1.12	0.19	1.22	#10-32x0.30prof.	0.197
32	~12	12.01 ~ 18	0.75	0.69	0.69	0.79	0.472	0.709 <sup>+0 -0.002</sup>	0.08	0.47	0.43 (0.47)	0.43 (0.47)	1.63	0.26	1.50	#10-32x0.30prof.	0.217
40	~12	12.01 ~ 32	0.75	0.69	0.69	1.02	0.630	0.984 <sup>+0 -0.002</sup>	0.08	0.51	0.47 (0.51)	0.39 (0.51)	1.63	0.26	1.85	1/4-28x0.47prof.	0.3
50	~12	12.01 ~ 48	0.88	0.84	0.75	1.26	0.787	1.181 <sup>+0 -0.002</sup>	0.08	0.55	0.51 (0.51)	0.47 (0.55)	2.07	0.32	2.28	5/16-24x0.63prof.	0.276
63	~12	12.01 ~ 27.5	0.88	0.84	0.75	1.50	0.787	1.260 <sup>+0 -0.002</sup>	0.08	0.55	0.51 (0.51)	0.47 (0.55)	2.07	0.32	2.83	3/8-24x0.63prof.	0.276

Código D.I. Tubo	KA	MM	NA	P	S	TA	TB	TC	TD <sub>H9</sub>	TE	TF	TG	W	WA	WB	ZZ
20	0.24	1/4-28 UNF	0.94	NPT1/8	2.72 (3.03)	0.43	0.43 (0.43)	M5x0.8	0.315	0.157	0.020	0.217	40°	0.551	0.551 (0.551)	3.80 (4.11)
25	0.31	5/16-24 UNF	1.14	NPT1/8	2.72 (3.03)	0.43	0.43 (0.43)	M6x0.75	0.394	0.197	0.039	0.256	40°	0.551	0.511 (0.511)	3.92 (4.23)
32	0.39	7/16-20 UNF	1.42	NPT1/8	2.80 (3.11)	0.43	0.39 (0.43)	M8x1.0	0.472	0.217	0.049	0.295	30°	0.551	0.511 (0.511)	4.51 (4.82)
40	0.55	7/16-20 UNF	1.73	NPT1/8	3.07 (3.43)	0.47	0.39 (0.47)	M10x1.25	0.551	0.236	0.049	0.315	20°	0.629	0.590 (0.629)	4.78 (5.14)
50	0.71	1/2-20 UNF	2.17	NPT1/4	3.54 (4.02)	0.51	0.47 (0.51)	M12x1.25	0.630	0.295	0.079	0.394	20°	0.629	0.629 (0.629)	5.69 (6.17)
63	0.71	1/2-20 UNF	2.72	NPT1/4	3.54 (4.02)	0.51	0.47 (0.51)	M14x1.5	0.709	0.453	0.118	0.571	20°	0.708	0.708 (0.708)	5.69 (6.17)

( ): Dimensiones para carrera larga.

Instalación de un sensor final de carrera

Sensor final de carrera: RCM

Abrazadera del sensor final de carrera: BMG\*\*

Unidad: pulgadas

Código D.I. Tubo	A	B	C	D	E
20	0.9449	1.4764	0.2756	0.6299	1.1024
25	1.0433	1.6732	0.2756	0.6299	1.1024
32	1.2008	1.9882	0.2756	0.6299	1.1024
40	1.3780	2.3425	0.2756	0.6299	1.1024
50	1.5945	2.7756	0.2756	0.6299	1.1024
63	1.8701	3.3268	0.2756	0.6299	1.1024

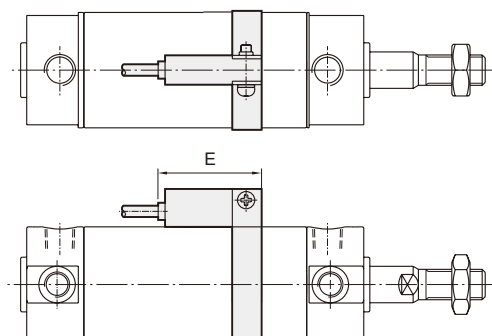
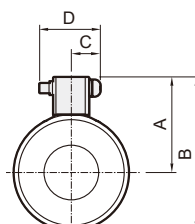

CILINDRO REDONDO

LB

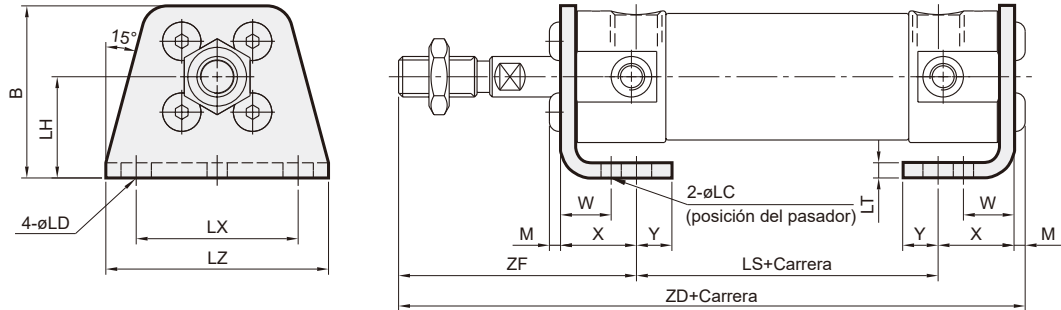

Unidad: pulgadas

Código D.I. Tubo	B	LC	LD	LH	LS	LT	LX	LZ	M	W	X	Y	ZD	ZF
20	1.34	0.16	0.24	0.79	1.78 (2.09)	0.12	1.26	1.73	0.09	0.39	0.59	0.28	3.93 (4.24)	1.47
25	1.52	0.16	0.24	0.87	1.78 (2.09)	0.12	1.42	1.93	0.11	0.39	0.59	0.28	4.07 (4.38)	1.59
32	1.77	0.16	0.26	0.98	1.78 (2.09)	0.12	1.73	2.28	0.11	0.39	0.63	0.31	4.66 (4.97)	2.14
40	2.15	0.16	0.26	1.18	2.01 (2.37)	0.12	2.13	2.80	0.13	0.39	0.65	0.33	4.95 (5.31)	2.16
50	2.78	0.20	0.35	1.57	2.16 (2.64)	0.18	2.60	3.39	0.17	0.69	0.87	0.43	5.96 (6.44)	2.76
63	3.25	0.20	0.43	1.77	2.16 (2.64)	0.18	3.23	4.17	0.22	0.69	0.87	0.51	6.01 (6.49)	2.76

( ): Dimensiones para carrera larga.

FAC

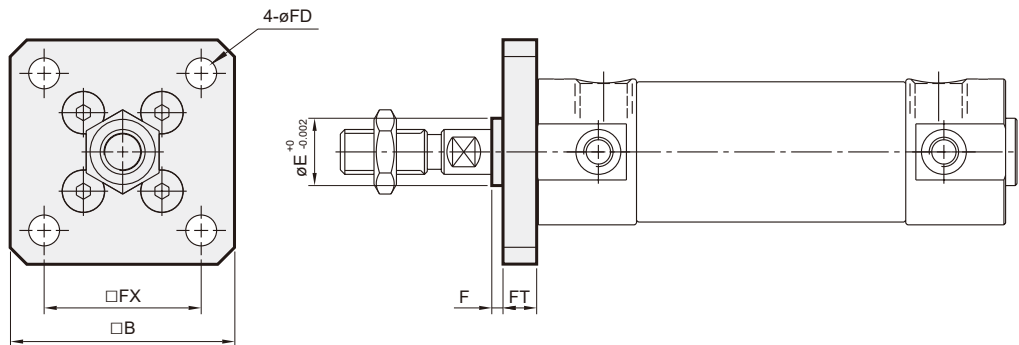

FBC

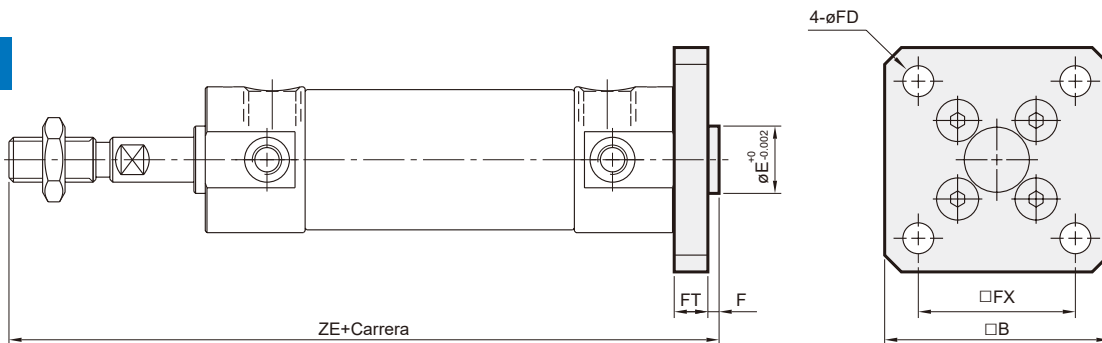

Unidad: pulgadas

Código D.I. Tubo	B	E	F	FX	FD	FT	ZE
20	1.57	0.472	0.08	1.10	0.22	0.24	4.04 (4.35)
25	1.73	0.551	0.08	1.26	0.22	0.28	4.20 (4.51)
32	2.09	0.709	0.08	1.50	0.26	0.28	4.79 (5.10)
40	2.40	0.984	0.08	1.81	0.26	0.31	5.09 (5.45)
50	2.99	1.181	0.08	2.28	0.35	0.35	6.04 (6.52)
63	3.62	1.260	0.08	2.76	0.43	0.35	6.04 (6.52)

( ): Dimensiones para carrera larga.

CILINDRO REDONDO

CA

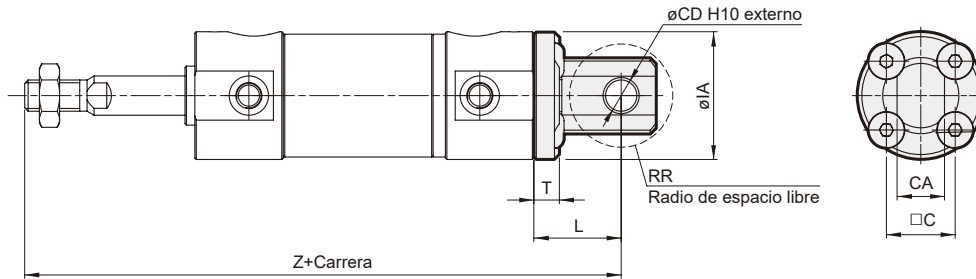

Unidad: pulgadas

Código D.I. Tubo	C	CA	CD	IA	L	RR	T	Z
20	0.55	0.38	0.25	1.02	0.70	0.42	0.20	4.42(4.73)
25	0.65	0.38	0.25	1.22	0.68	0.75	0.21	4.52(4.83)
32	0.79	0.5	0.25	1.49	1.07	0.60	0.47	5.50(5.81)
40	1.02	0.62	0.375	1.85	0.88	0.65	0.25	5.58(5.94)
50	1.26	0.75	0.375	2.28	0.91	0.38	0.29	6.52(7)
63	1.5	0.75	0.375	2.83	0.91	0.38	0.29	6.52(7)

( ): Dimensiones para carrera larga.

CB SDB+Pasador (compra adicional)

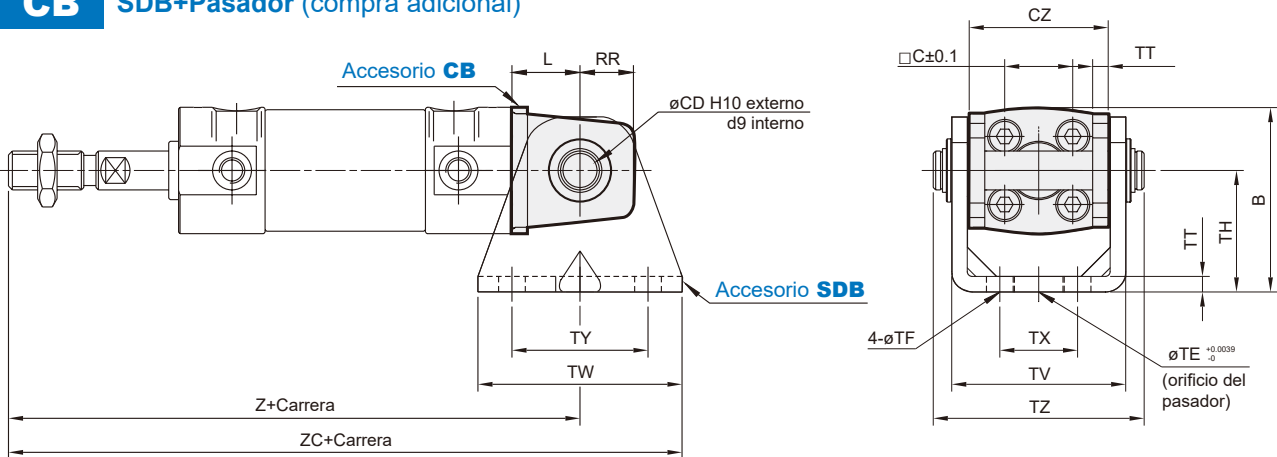

Unidad: pulgadas

Código D.I. Tubo	B	CD	CZ	L	RR	TE	TF	TH	TT	TV	TW	TX	TY	TZ	Z	ZC
20	1.50	0.315	1.14	0.55	0.43	0.394	0.22	0.98	0.13	1.41	1.65	0.63	1.10	1.71	4.27 (4.58)	5.10 (5.41)
25	1.79	0.394	1.30	0.63	0.51	0.394	0.22	1.18	0.13	1.57	1.65	0.79	1.10	1.89	4.47 (4.78)	5.30 (5.61)
32	2.13	0.472	1.57	0.79	0.59	0.394	0.26	1.38	0.18	1.94	1.89	0.87	1.10	2.34	5.22 (5.53)	6.16 (6.47)
40	2.50	0.551	1.93	0.87	0.71	0.394	0.26	1.57	0.18	2.30	2.20	1.18	1.18	2.81	5.57 (5.93)	6.67 (7.03)
50	3.11	0.630	2.36	0.98	0.79	0.787	0.35	1.97	0.24	2.85	2.52	1.42	1.42	3.39	6.59 (7.07)	7.85 (8.33)
63	3.78	0.709	2.91	1.18	0.87	0.787	0.43	2.36	0.31	3.56	2.91	1.81	1.81	4.15	6.79 (7.27)	8.25 (8.73)

( ): Dimensiones para carrera larga.

**SDB** TA/TB (compra adicional)

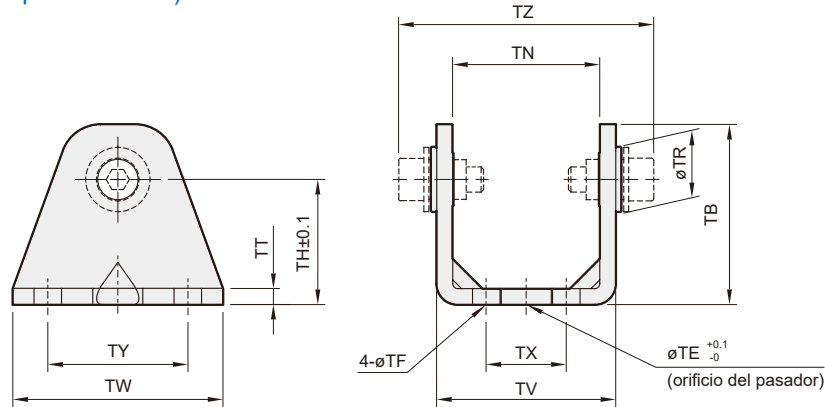

**SDB-R**

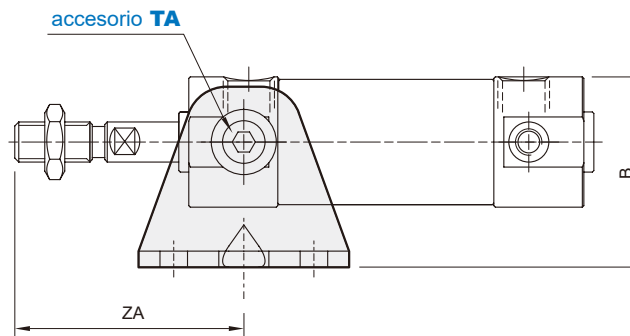

**SDB-H**

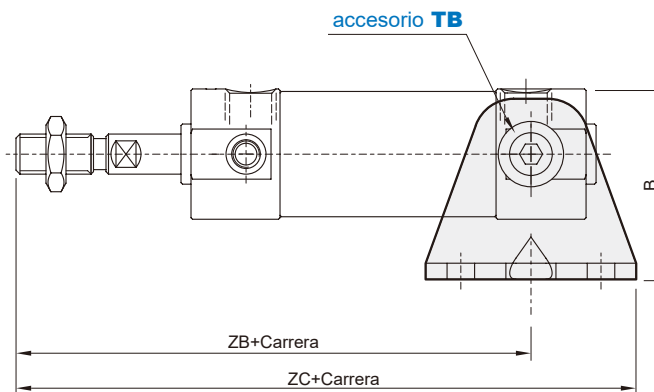

Unidad: pulgadas

Código D.I. Tubo	B	TB	TE	TF	TH	TN	TR	TT	TV	TW	TX	TY	TZ	ZA	ZB	ZC	Modelo (Pasador O.D.)
20	1.50	1.42	0.394	0.22	0.98	1.15	0.55	0.13	1.41	1.65	0.63	1.10	2.00	1.43	3.29(3.6)	3.80(4.11)	0.315 -0.0016 -0.0030
25	1.79	1.69	0.394	0.22	1.18	1.30	0.63	0.13	1.57	1.65	0.79	1.10	2.29	1.55	3.41(3.72)	3.92(4.23)	0.394 -0.0016 -0.0030
32	2.13	1.97	0.394	0.26	1.38	1.59	0.71	0.18	1.94	1.89	0.87	1.10	2.81	2.06	4.04(4.31)	4.51(4.82)	0.472 -0.0020 -0.0037
40	2.50	2.28	0.394	0.26	1.57	1.94	0.87	0.18	2.30	2.20	1.18	1.18	3.48	2.10	4.31(4.59)	4.78(5.14)	0.551 -0.0020 -0.0037
50	3.11	2.76	0.787	0.35	1.97	2.38	0.98	0.24	2.85	2.52	1.42	1.42	4.29	2.58	5.14(5.58)	5.69(6.17)	0.630 -0.0020 -0.0037
63	3.78	3.23	0.787	0.43	2.36	2.94	1.06	0.31	3.56	2.91	1.81	1.81	5.15	2.58	5.14(5.58)	5.69(6.17)	0.709 -0.0020 -0.0037

( ): Dimensiones para carrera larga.



**TA** Muñón parte delantera

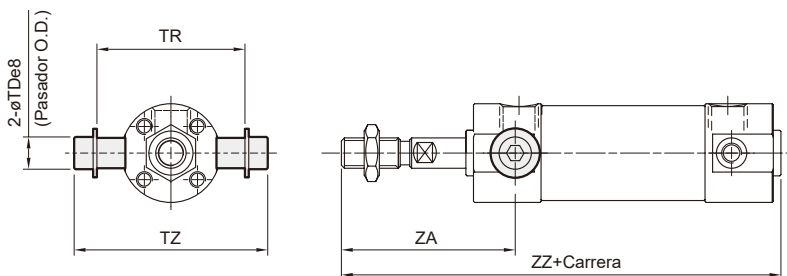

Unidad: pulgadas

Código D.I. Tubo	TB	TDe8	TR	TZ
20	0.43(0.43)	0.315	1.54	2.00
25	0.43(0.43)	0.394	1.69	2.29
32	0.39(0.43)	0.472	2.11	2.81
40	0.39(0.47)	0.551	2.54	3.48
50	0.47(0.51)	0.630	3.15	4.29
63	0.47(0.51)	0.709	3.86	5.15

( ): Dimensiones para carrera larga.

**TB** Muñón parte trasera

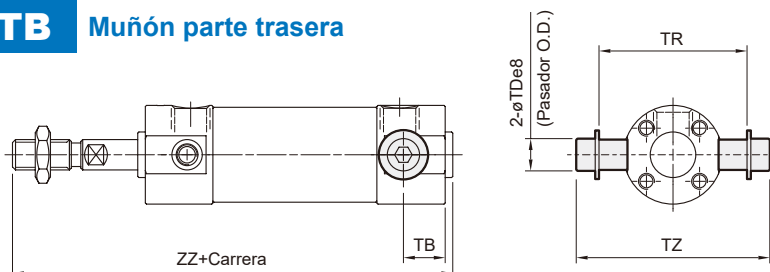

Unidad: pulgadas

Código D.I. Tubo	ZA	ZB	ZZ
20	1.43	3.29 (3.60)	3.80 (4.11)
25	1.55	3.41 (3.72)	3.92 (4.23)
32	2.06	4.04 (4.31)	4.51 (4.82)
40	2.10	4.31 (4.59)	4.78 (5.14)
50	2.58	5.14 (5.58)	5.69 (6.17)
63	2.58	5.14 (5.58)	5.69 (6.17)

( ): Dimensiones para carrera larga.

**PASADOR**

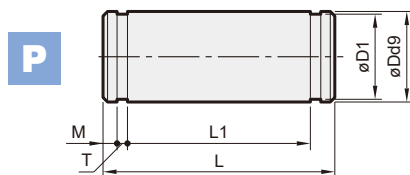

para CB

Unidad: pulgadas

Código D.I. Tubo	Dd9	D1	L	L1	M	T	Anillo elástico
20	0.315 <sup>-0.0016</sup> <sub>-0.0030</sub>	0.30	1.71	1.52	0.06	0.04	STW-8
25	0.394 <sup>-0.0016</sup> <sub>-0.0030</sub>	0.38	1.89	1.68	0.06	0.05	STW-10
32	0.472 <sup>-0.0020</sup> <sub>-0.0037</sub>	0.45	2.34	2.13	0.06	0.05	STW-12
40	0.551 <sup>-0.0020</sup> <sub>-0.0037</sub>	0.53	2.81	2.56	0.08	0.05	STW-14
50	0.630 <sup>-0.0020</sup> <sub>-0.0037</sub>	0.60	3.39	3.13	0.08	0.05	STW-16
63	0.709 <sup>-0.0020</sup> <sub>-0.0037</sub>	0.67	4.15	3.85	0.10	0.05	STW-18

**CILINDRO REDONDO**

**TA Muñón parte delantera**

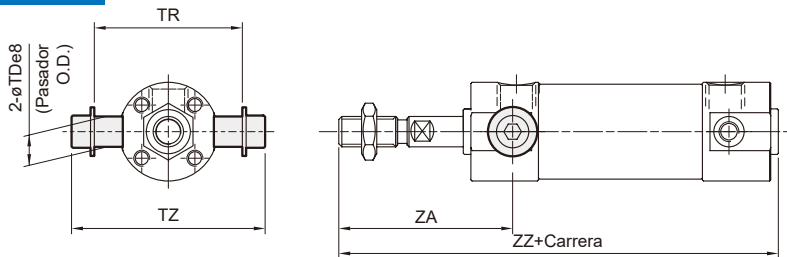

**TB Muñón parte trasera**

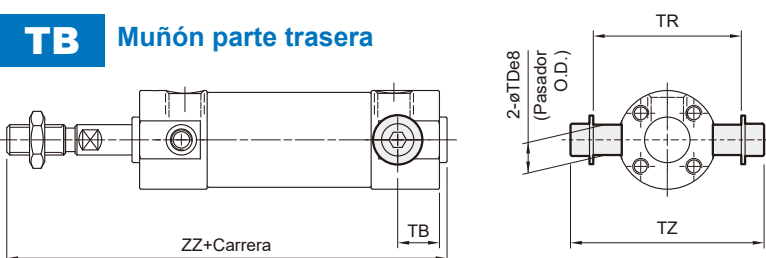

Código D.I. Tubo	TB	TDe8	TR	TZ	ZA	ZZ
20	11(11)	8 <sup>-0.025</sup> <sub>-0.047</sub>	39	51	46	106 (114)
25	11(11)	10 <sup>-0.025</sup> <sub>-0.047</sub>	43	58.2	51	111 (119)
32	10(11)	12 <sup>-0.032</sup> <sub>-0.059</sub>	53.5	71.5	51	113 (121)
40	10(12)	14 <sup>-0.032</sup> <sub>-0.059</sub>	64.5	88.5	62	130 (139)
50	12(13)	16 <sup>-0.032</sup> <sub>-0.059</sub>	80	109	71	150 (162)
63	12(13)	18 <sup>-0.032</sup> <sub>-0.059</sub>	98	131	71	150 (162)

( ): Dimensiones para carrera larga.

**MCCG / MCCN**

**SDB-R(H) / TA / TB Procedimientos de montaje**

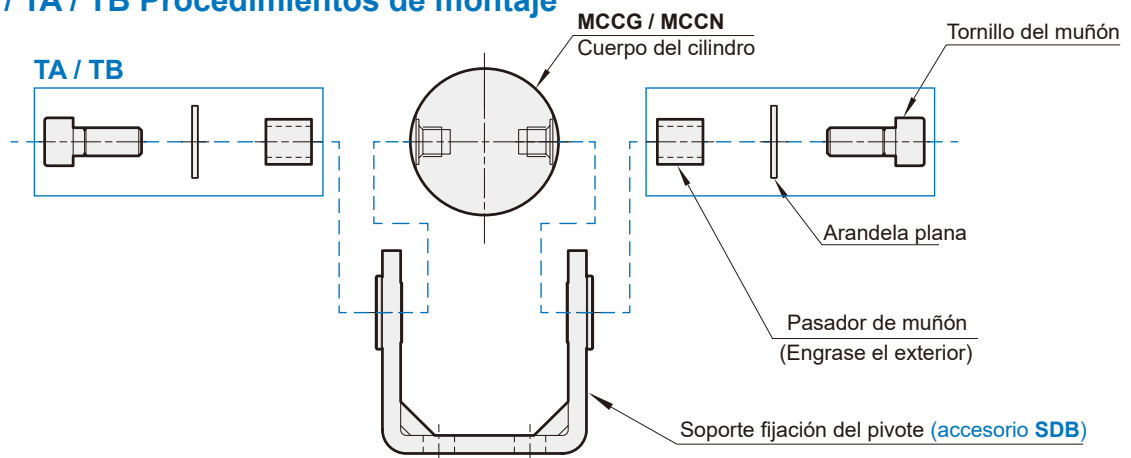



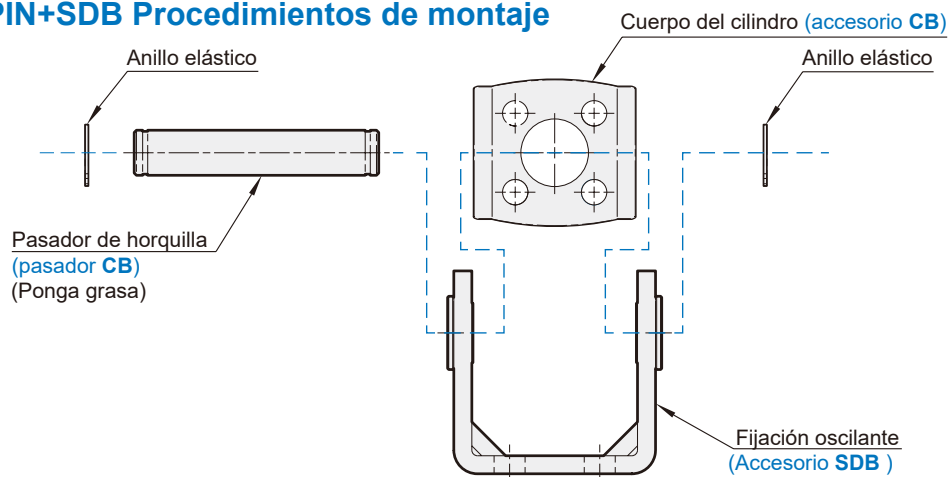

**CB+PIN+SDB Procedimientos de montaje**









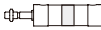

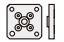

## CILINDRO REDONDO

### Peso del cilindro

Unidad: kg

Modelo	Carrera	Peso básico		Peso básico (magnético)		Carrera 25 mm
		MCCN-11	MCCN-11-A	MCCN-11-M	MCCN-11-M-A	
D.I. Tubo						
20	~200	0.107	0.112	0.108	0.113	0.022
	201~350	0.117	0.122	0.118	0.123	
25	~300	0.165	0.165	0.166	0.166	0.03
	301~400	0.178	0.178	0.179	0.179	
32	~300	0.233	0.237	0.234	0.238	0.043
	301~450	0.261	0.265	0.262	0.266	
40	~300	0.402	0.413	0.414	0.425	0.067
	301~800	0.44	0.451	0.452	0.463	
50	~300	0.753	0.782	0.77	0.799	0.1
	301~1200	0.838	0.867	0.855	0.884	
63	~300	1.058	1.076	1.078	1.096	0.119
	301~700	1.192	1.21	1.212	1.23	

### Peso de los accesorios

Modelo	LB	CB	FAC / FBC	SDB	TA / TB	Y	I	PIN-Y-P (con anillo elástico)	PIN-CB-P (con anillo elástico)	Tuerca vástago
D.I. Tubo										
20	0.0434	0.037	0.066	0.089	0.012	0.0352	0.0318	0.0088	0.0174	0.002
25	0.0543	0.051	0.092	0.111	0.018	0.0622	0.0598	0.0164	0.03	0.004
32	0.072	0.096	0.136	0.202	0.038				0.053	
40	0.089	0.147	0.208	0.311	0.068	0.093	0.07	0.0262	0.086	0.01
50	0.24	0.272	0.364	0.545	0.114	0.182	0.151	0.0618	0.135	
63	0.352	0.488	0.521	0.725	0.176				0.2116	0.013